



Factory Five Racing, Inc.

Hot Rod

Assembly manual revision 1V update

Table of Contents

Door Hinge/frame/Door assembly	1
Engine side covers	3
Transmission Tunnel Cover	3
Fuel Tank	5
Master Cylinders	6
Striker cover	6
Fuel tank side cover	7
Headlight connections	8

Door Hinge/frame/Door assembly

- ✂ $\frac{3}{16}$ " hex key, $\frac{1}{2}$ ", $\frac{5}{8}$ " wrenches, $\frac{1}{2}$ ", $\frac{3}{4}$ " sockets, ratchet, saw, marker, drill, $\frac{1}{8}$ ", $\frac{3}{16}$ ", $\frac{5}{16}$ ", $\frac{1}{2}$ " drill bits, $\frac{3}{4}$ " hole saw, masking tape, Bubble level, clamps
- 🚗 Door Hinge assembly, 33 door handle components, door frame components

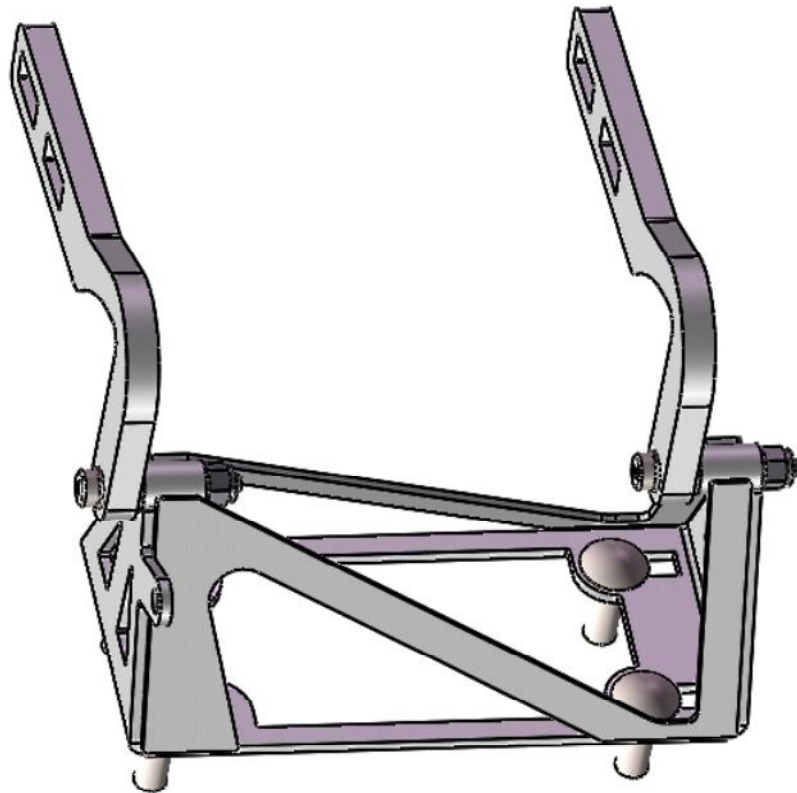
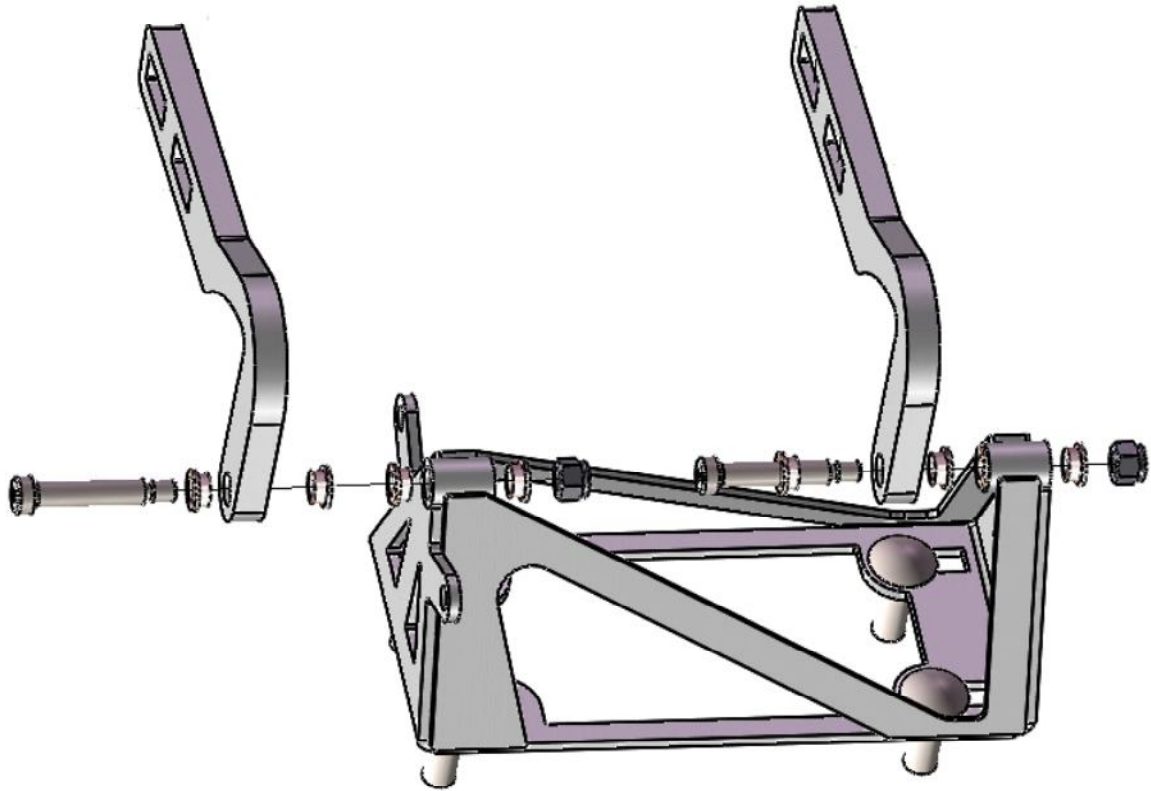

Attach the hinge arms to the hinge arm standoffs as shown. The hinge arms go on top of the mounts with the bronze bushings pushed into both sides of the arm and both sides of the hinge arm standoffs.

Engine side covers

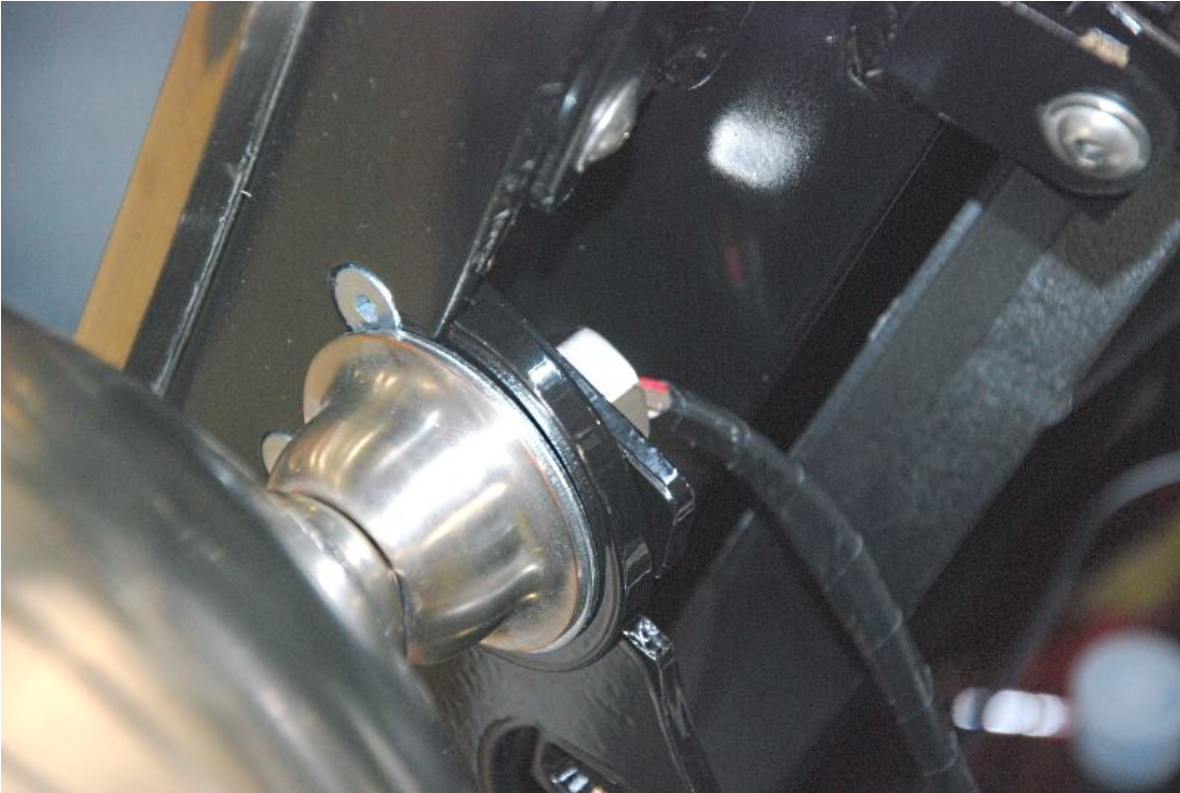

- 👉 Headlights are bolted through the side covers. If you plan to take your side covers on and off and not have to thread each wire through the nut and have to realign the headlight each time a good idea is to make a spacer to go on the radiator mount and cut the side covers to go around the spacer so headlight removal is not necessary.

Transmission Tunnel Cover

- ✂ Jig saw or air saw, 1/4" drill bit, drill, marker, masking tape, 1/4" hex drive bit, silicone, sanding tool, measuring tape, clamps.
- 🚗 Mounted aluminum/components, body finish components, shifter boot components
- 👉 The pictures shown are of the older tunnel but the process is similar.
- 👉 The transmission tunnel is designed to be adjustable to allow maximum foot room for every engine/transmission combination.

Insert the fiberglass transmission tunnel into the cockpit.

Look at the bellhousing to tunnel clearance. It is advisable to have at least 1/2" clearance between the bellhousing and the tunnel to allow the engine to torque under acceleration without hitting.

Measure both sides of the engine to ensure clearance.

If there is enough bellhousing clearance, remove the transmission tunnel.



Cut the middle area fiberglass holding the two sides of the transmission tunnel together at the front the same amount measured before.

Place the tunnel in the cockpit check clearance to the bellhousing.

Check the hole for the emergency brake handle. If necessary, mark and cut the hole opening in the flange.

Drill and rivet the tunnel to the floor.



Cut the center of the transmission tunnel so that it sits down on the transmission tunnel flange.

Fuel Tank

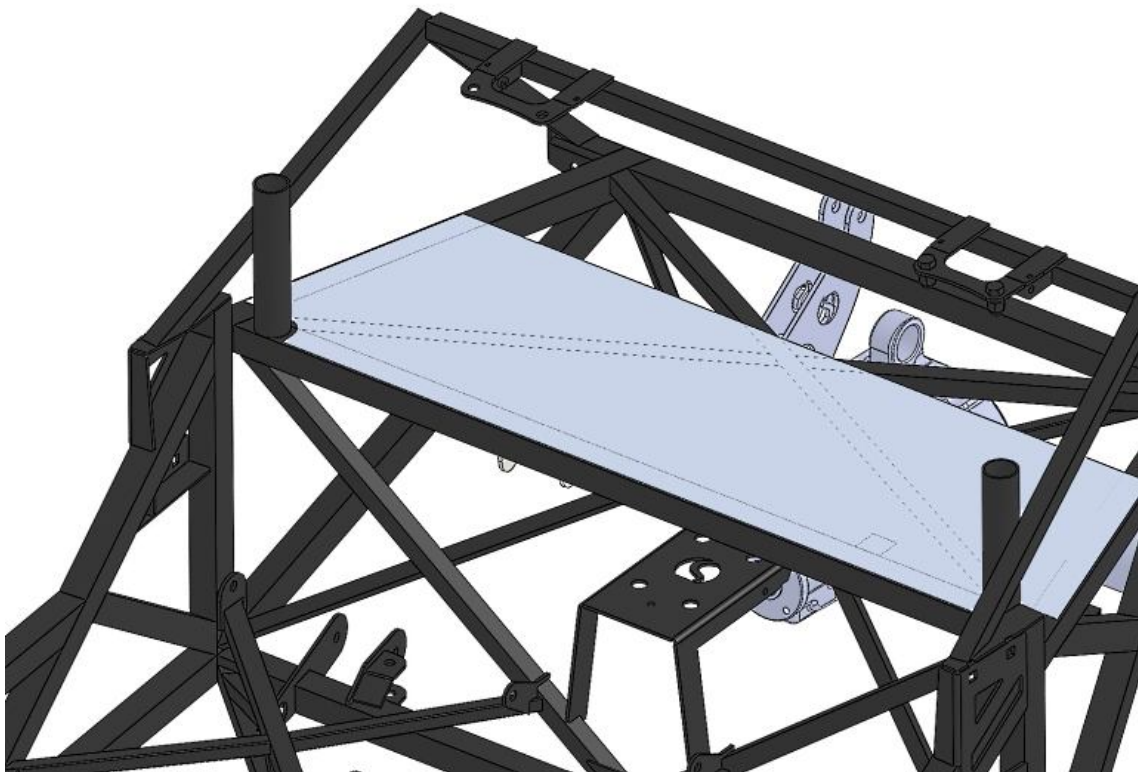

Install the front aluminum floor that goes under the front of the fuel tank.

Master Cylinders

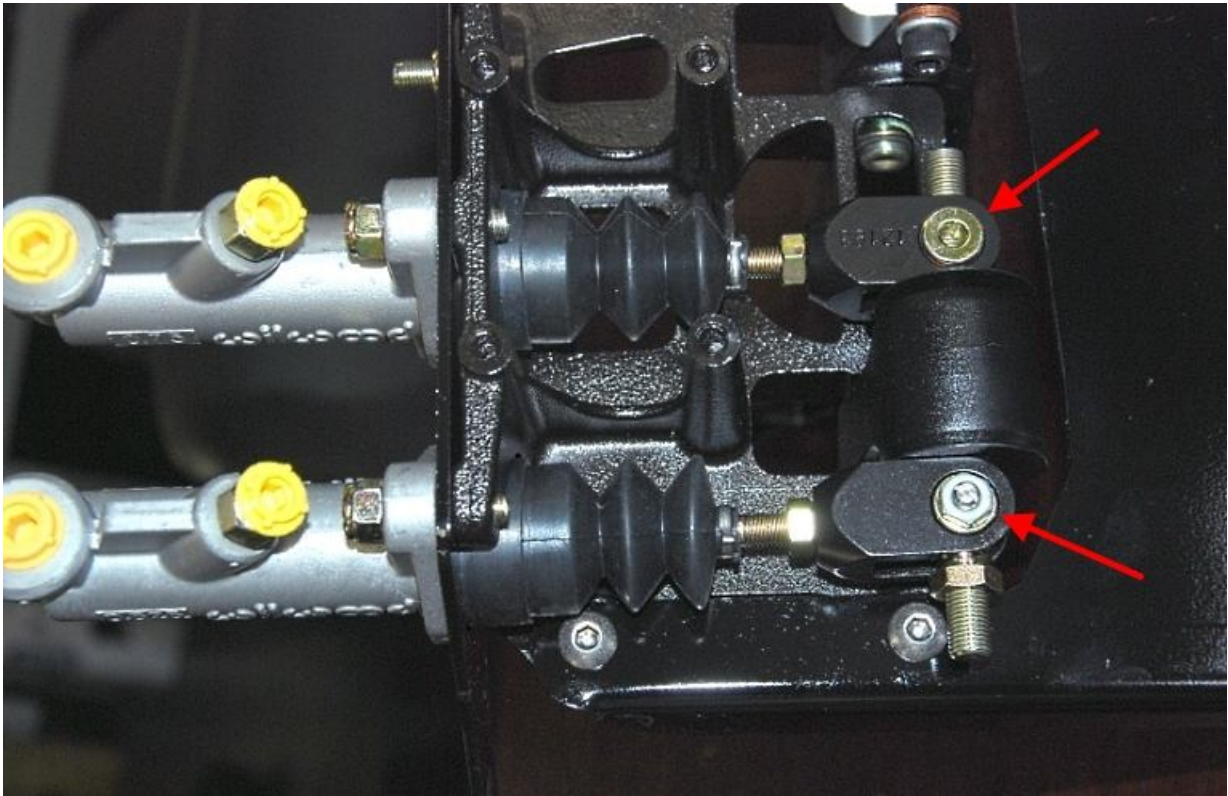

☞ The brake pedal master cylinder pushrod mounts are different from each other. Only one has a screw and nut. This is normal.

Striker cover

- ✂ Drill, $\frac{1}{8}$ " drill bit, rivet tool, silicone, silicone gun
- 🛠 Packaged aluminum, Secondary body fasteners

Push weatherstrip onto the aluminum striker covers on the outside where it will seal against the body.

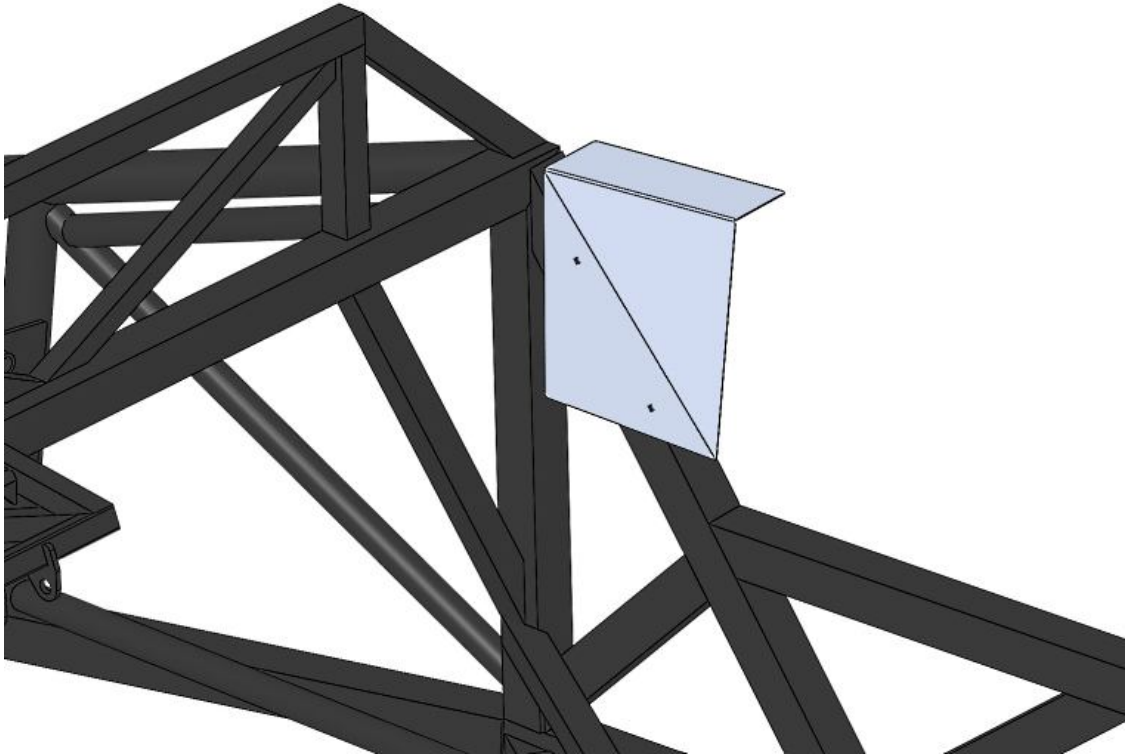

With the door hinge and latch adjusted, position the striker cover.

Silicone and rivet the panel in place.

Fuel tank side cover

- ✂ Drill, $\frac{1}{8}$ " drill bit, rivet tool, silicone, silicone gun
- 🔧 Packaged aluminum, Secondary body fasteners



Push weatherstrip onto the top, outside and front edges of the cover panel. Insert and locate the panel so that the weatherstrip seals against the outside body and behind the door.

Silicone and rivet the panel in place.

Headlight connections

	Chassis harness	Headlight
Ground	Black	Black
High Beam	Brown	Red
Low Beam	Red	Green
Park	Tan	Red
Left Turn	Dark Green	White
Right Turn	Light Blue	White