



Factory Five Racing, Inc.

Part Number: 15471	Revision:2A	Effective Date: 04/17/19	By: J. INGERSLEV
Document Type (indicate):	° Bill of Material	° Drawing (may be attached)	° Specification
	• Assembly Instructions	° Operating Procedure	° Other

Roadster Coyote Engine

Installation Instructions



Parts needed	3
Ford Performance Parts.....	3
Ford Motor Co. Parts	3
Summit Racing.....	3
Fuel System.....	3
Air Intake System.....	3
Other vendors.....	4
Autozone	4
Supplies.....	4
Information.....	4
Accelerator Pedal	5
Fuel pressure regulator.....	11
Drivetrain	14
Engine prep	14
Clutch.....	14
Torque Specs.....	15
Exhaust.....	15
Oil Pan	15
Engine mounts.....	23
Oil Pressure sender.....	25
Water Temp Sender	28
Oil pressure sender.....	32
Transmission Prep.....	33

Engine/Transmission Installation	35
Alternator	35
Shifter handle	37
Fuel System	38
Fuel lines	38
Fuel pressure regulator vacuum.....	39
Cooling system.....	41
Heater core bypass hose	44
Air Intake	47
Mass Air Meter	47
Spectre assembly	48
Intake tube.....	52
Spectre MAF Sensor	52
Treadstone MAF Sensor	54
Vacuum ports and PCV vent.....	56
Valve cover hoses	57
CMVV Vacuum hose	59
Clutch position switch.....	59
Wiring	63
Computer mounting.....	63
Harness install	63
Engine bay.....	67
Alternator	71
Intercooler wire	73
Radiator Cooling Fan	74
Fuel Pump	74
Battery power	76
Start power	77
Tach	81
Oil Pressure and Water temp sensors	85
OBD 2 Port	86
Clutch cable.....	87
Exhaust.....	88
O ₂ Harness.....	88
Starting the engine.....	89

Parts needed

Ford Performance Parts

M-6007-M50A - 5.0L Engine
M-6017-A504V – 2015 & newer 5.0L engine control pack
M-7003-R58C - TKO transmission
M-7771-A – Bellhousing bolt kit
M-9680-M50 – 5.0L engine cover kit
M-7007-A – Transmission Sandwich plate
M-6392-M46 - Bellhousing
M-7560-T46 – Clutch kit
M-7515-A – Clutch fork
M-6375-G46A – Flywheel (If not already on engine)
M-7548-A – Clutch Release Bearing or Ford motor F7ZZ.7548.AA
M-6397-B46 – Clutch bolt kit
M-7600-B – Pilot bearing (If not already on engine)
M-8600-M50BALT – 5.0 Alternator Kit



Ford Motor Co. Parts

F3LY-6C070-A – Flywheel access hole plug
BR3Z-8260-BA – Mustang upper radiator hose
W500310.S438- Starter bolts (3 needed)
BR3Z-6379-A – Flywheel bolt (8 needed)
AL3Z-6890-A – 2015 & newer only - Oil filter nipple to eliminate oil cooler spacer plate.
GR3Z-11002-A – 2016 Starter. This starter is 3” shorter than the March 2015 and earlier Mustang starter

Summit Racing

FUEL SYSTEM



Ford Performance does not recommend the Corvette fuel filter/pressure regulator

AEI-13129 – 6AN Fuel pressure regulator
SUM-220166B – 6AN O-ring to straight 6AN Adapter (2 needed)
SUM-220701-B – 6AN to -6AN Hose Barb (1 needed)
FRA-495110-BL – 6AN O-ring to straight -4AN Adapter (1 needed)
SUM-220700-B – 4AN Hose Barb (1 needed)
SUM-220711-B – 90° -6AN to -6AN Hose Barb (1 needed)
SUM-800199 – 0-100 EFI fuel pressure gauge
GSL392BX – Fuel Pump or VOR-8F002-265 Fuel pump
VPN-400-939 – Fuel pump mount/barbs for GSL392BX pump

AIR INTAKE SYSTEM



Two possibilities

SPE-9741 – 4” to 3.50” Reducer adapter
SPE-9771 - 4” hose coupling

SPE-9799 - 4" 90 ° intake tube – Requires putting fitting in hose for PCV hose
SPE-9705 - Mass Air Sensor filter adapter
KNN-RU-5149 – 4" ID x 6.50" long Air Filter

Or use

www.treadstoneperformance.com – MAPHL35

FFR 16404 - 90° Silicone hose with fittings

FFR 16608 -air filter

Other vendors

AUTOZONE

Short oil filter - Fram PH10060 or Mobil M1-113 or STP S10060 or WIX 57060XP

Oil pan sensor plug – Dorman 65221

Morosso – Oil Pan (Coyote #20570 and pickup #24570)

Autometer Tach Adapter 9117 (Only if using Autometer Gauges)

Supplies

Oil – See instructions with engine - 8 quart

Coolant –2-3 gallons of **Dex-Cool concentrate**

Transmission fluid

Teflon tape



Information

These instructions are for 2015-2017 Coyote engines only. If using an older 2011-14 Coyote, download those instructions from www.parts.factoryfive.com/instructions .

These instructions assume that the customer has the Roadster Coyote Installation kit from Factory Five Racing.

Make sure to download the latest version of the engine controls instructions from the Ford Performance parts website: www.performanceparts.ford.com. Do a parts search for: M-6017-A504V and click on the instructions pdf.

Use the following diagram as a guide for harness locations.

1	Firewall extension
2	Engine starter
3	Engine computer
4	Power Distribution point
5	Black fuse box
6	OBD 2 port
7	Accelerator pedal
8	Engine connection

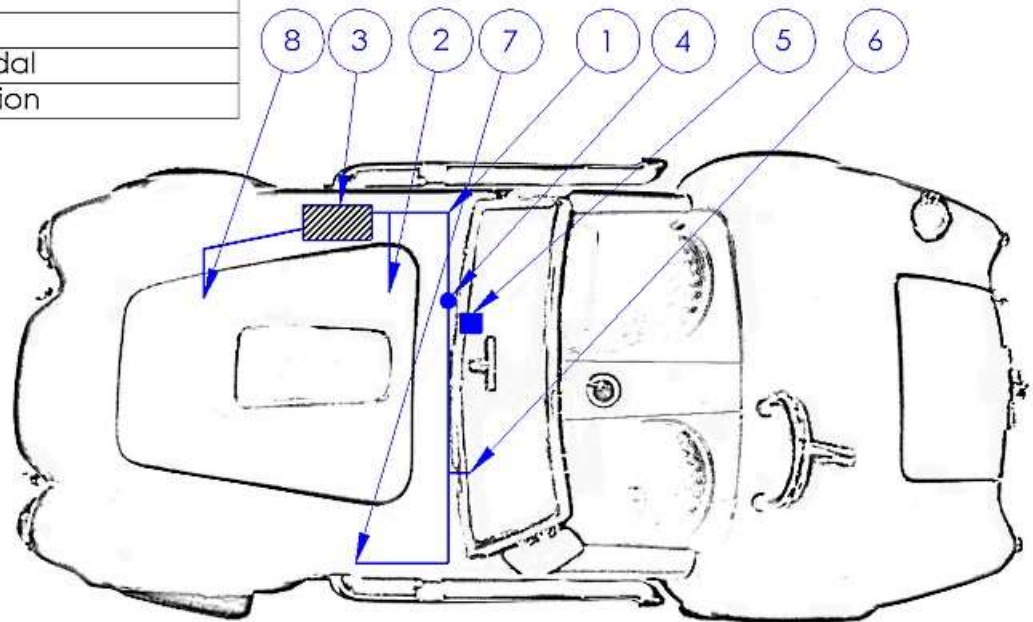

wiring layout

Accelerator Pedal

- ✂ Hack saw, T-25 Torx bit, ratchet, $\frac{7}{16}$ " wrench, silver Marker, Grinder or drill bit, clamp
- 🚗 Accelerator pedal, coyote accelerator install kit

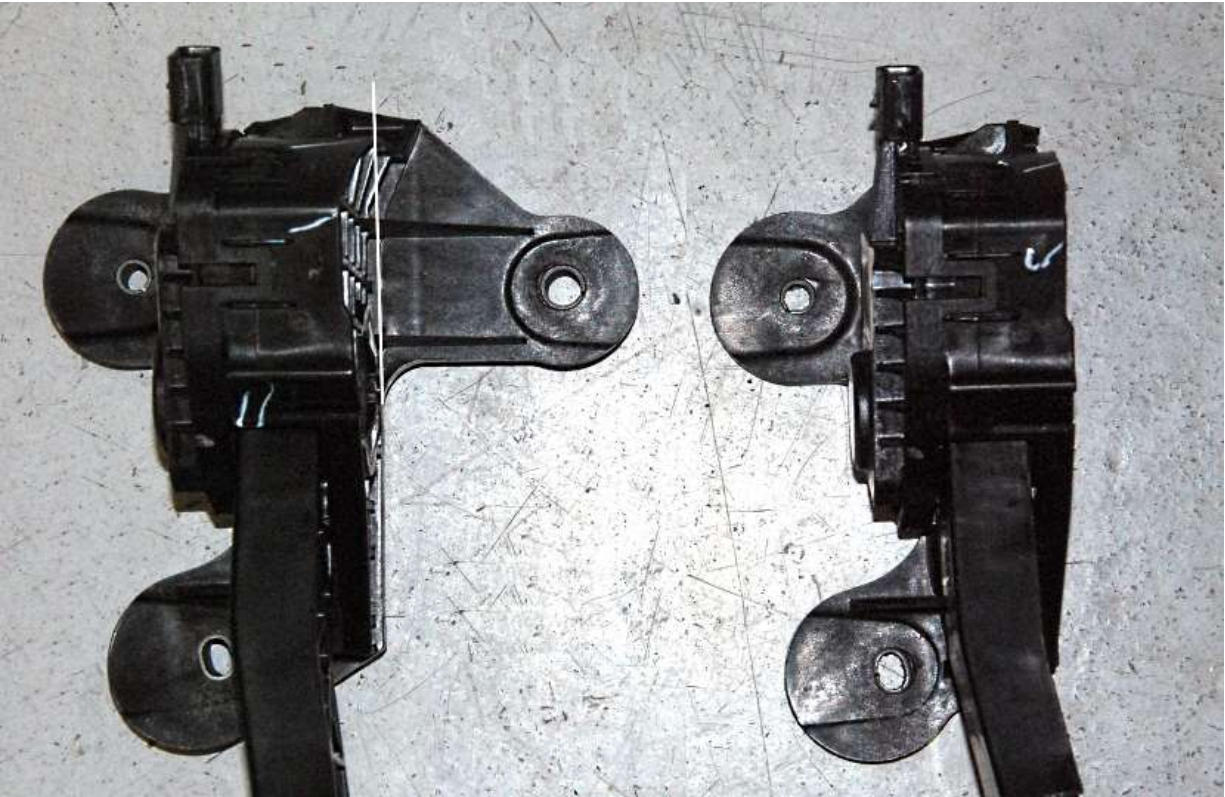

Use a hack saw to cut the right mount off the accelerator. Cut right against the flat section of the pedal so it also cuts the top Webbing off.

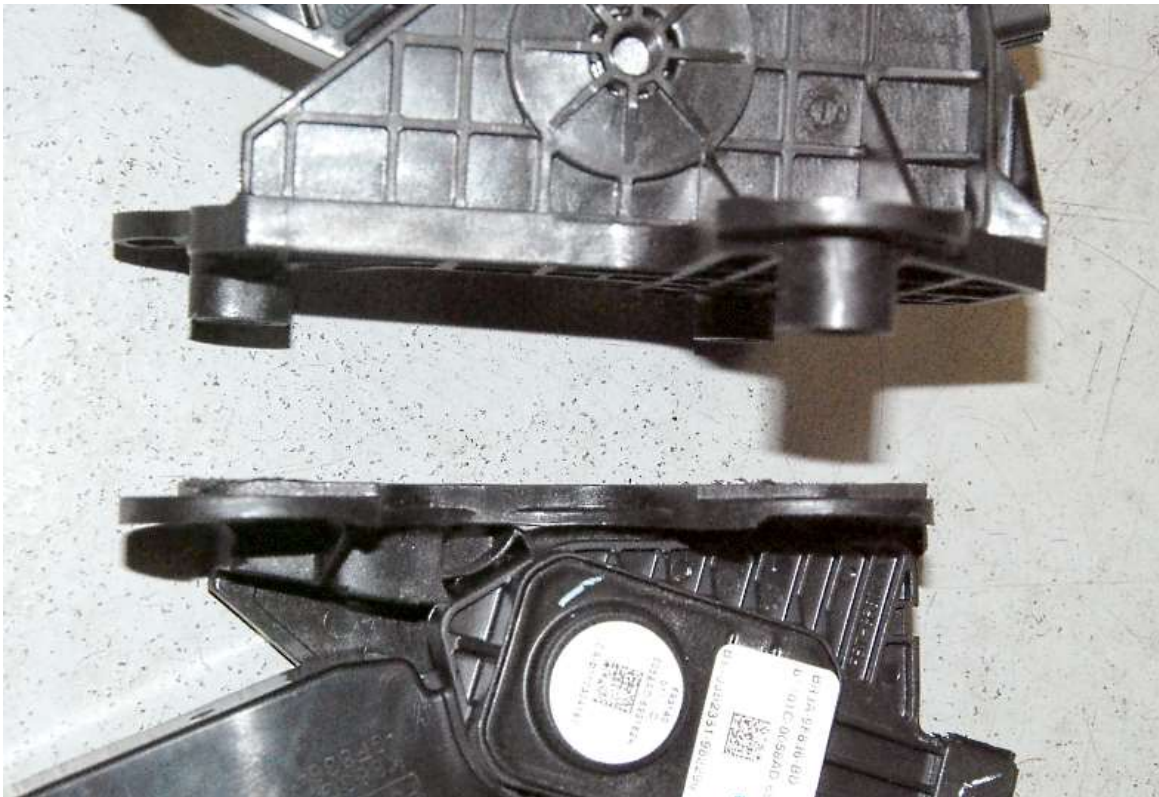

On the underside, cut the bottom mounts off with a hack saw so that the bottom is flat.



Use a T-25 torx bit and ratchet to remove the screw on the back of the accelerator pedal.



Turn the pedal pad around using the same screw hole.



Mark the pedal where the pad stops.



Cut the pedal with a hack saw then screw the pad back on.

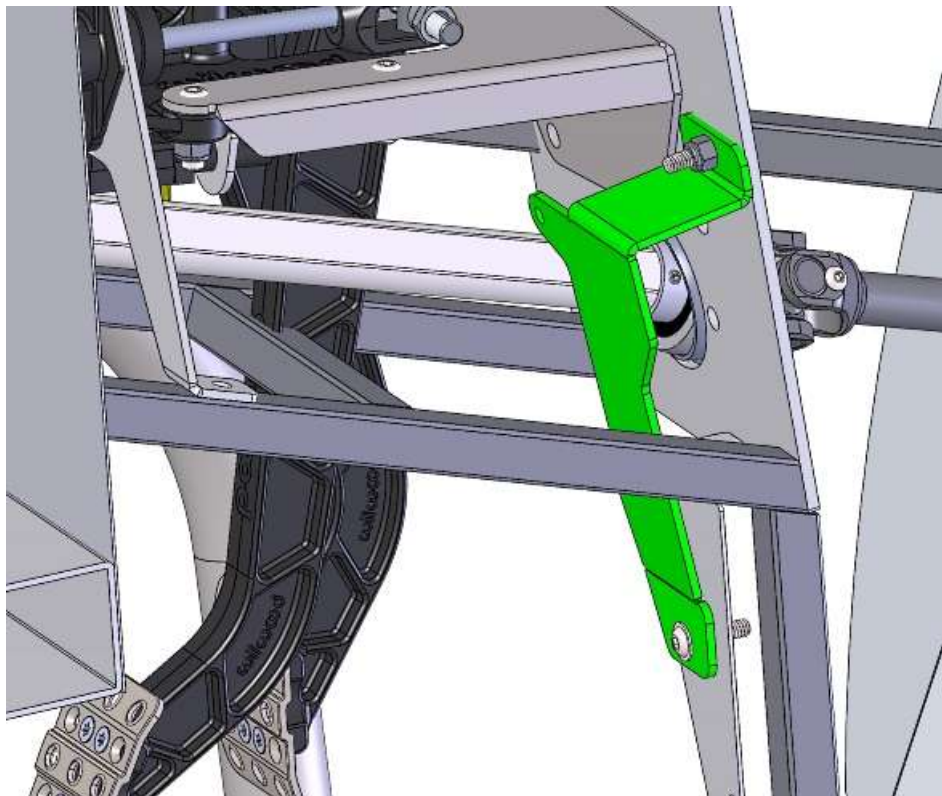

Attach the Accelerator pedal mount to the frame accelerator pedal mount using the 1/4" flange head screws, the top hole will have to be drilled through the aluminum from the inside using the front plate hole as a guide.

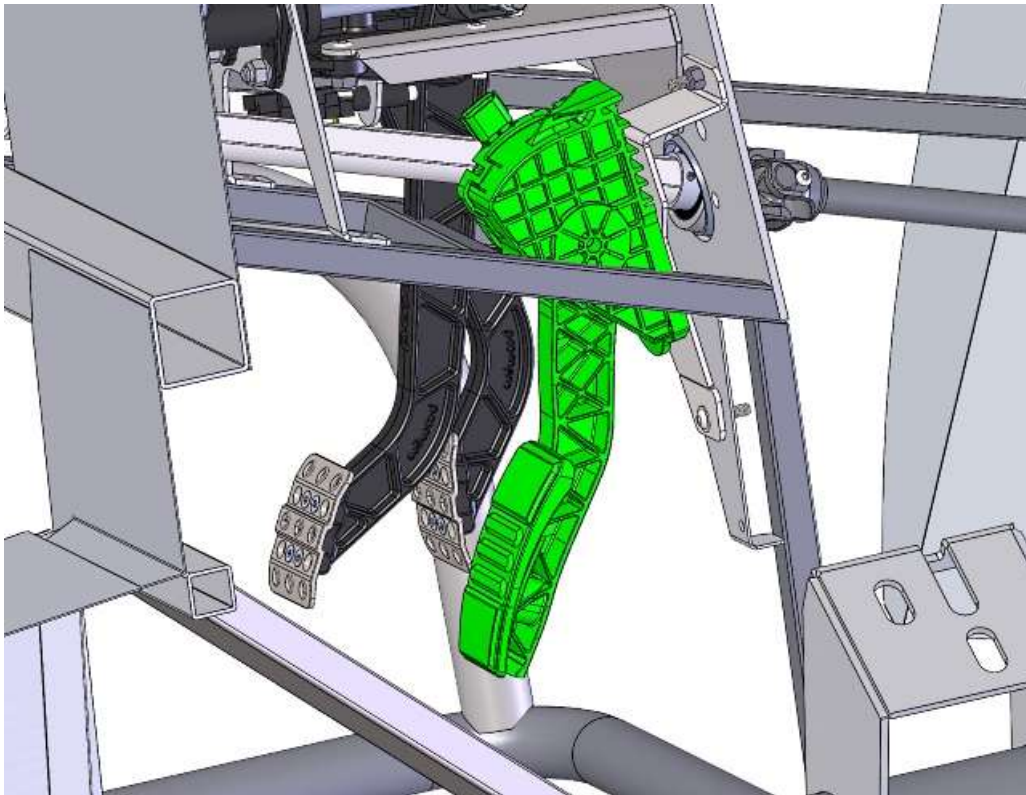

Mount the accelerator pedal using the remaining $\frac{1}{4}$ " fasteners.

Fuel pressure regulator



Decide where you would like to mount a fuel pressure regulator; on the firewall or the underside of the 2"x 2" tube depending on its mount.



Use a piece of tape to locate the mounting holes and make sure the regulator is not crooked tehndrill mounting holes.



Attach the regulator to the firewall.



Connect the appropriate fittings, the return is on the bottom.

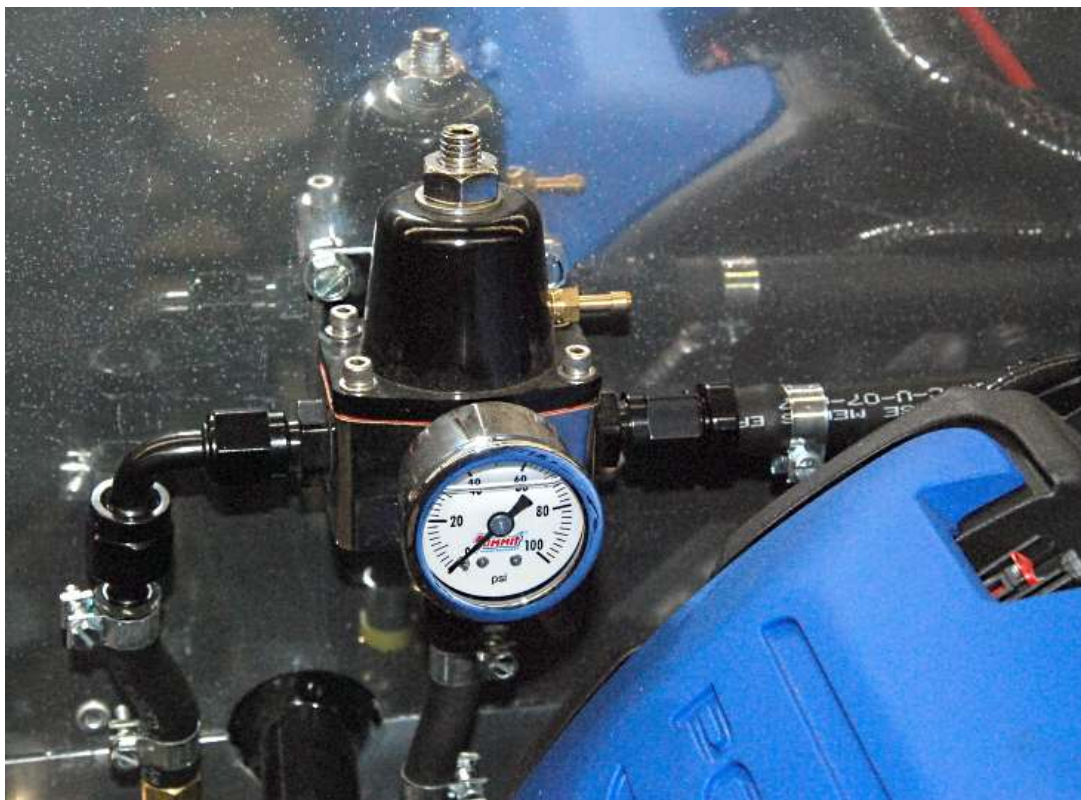

Push the $\frac{3}{8}$ " fuel line onto the right side of the regulator then attach a hose clamp and run it over to the engine fuel rail.

Drivetrain

Engine prep

- ✂ 6mm, 10mm, 13mm, 15mm sockets, 13mm deep socket, ratchet
- 🚗 Ford Racing, pipe fittings, Shallow oil pan
- 👤 Do not put the alternator on until after the engine is in.

Clutch



If not already done, install the flywheel and clutch on the engine.



If the clutch fork has a vibration damping weight on it, remove it from the clutch fork, it is not needed.

Attach the clutch fork to the bellhousing.

Attach the bellhousing to the engine.

TORQUE SPECS

FLYWHEEL TO CRANK	80	lbft
PRESSURE PLATE TO FLYWHEEL	35	lbft
BELLHOUSING TO ENGINE	35	lbft

Exhaust

Remove the Stock Mustang header.

Remove all of the header studs using a 6mm 6 point socket.

Oil Pan



Morosso Oil pan, Oil pan sensor plug



Ratchet, $\frac{3}{8}$ " hex key or socket, ratchet



Blow the oil pan and pick-up out before assembling the pan to the engine to make sure there is nothing in them.



Screw the oil pan sensor plug into the pan with the gasket on the plug.



Put Teflon tape onto the plugs included with the oil pan.



Screw the plugs into the oil pan using a $\frac{3}{8}$ " hex and ratchet.

Drain the oil pan on the engine of oil.



Remove all of oil pan bolts making a note of where the stud ones are so they go back in the same places.



Remove the screws holding the pick-up to the oil pump.



Remove the screw holding the pick-up to the post.



Put the o-ring included with the new pick-up onto the pick-up.



Insert the pick-up into the oil pump then check the alignment of the post screw hole. Sometimes the hole may be off slightly. If so, remove the pickup and hole the pick-up mount in a vise and oval the hole with a drill bit.



Insert the pick-up into the oil pump then by hand, screw the screws in.



By hand screw the screw into the post.



Torque the oil pump bolts per Fords spec. Torque to **10 Nm + 45 deg.**



The next step is easier with two people.

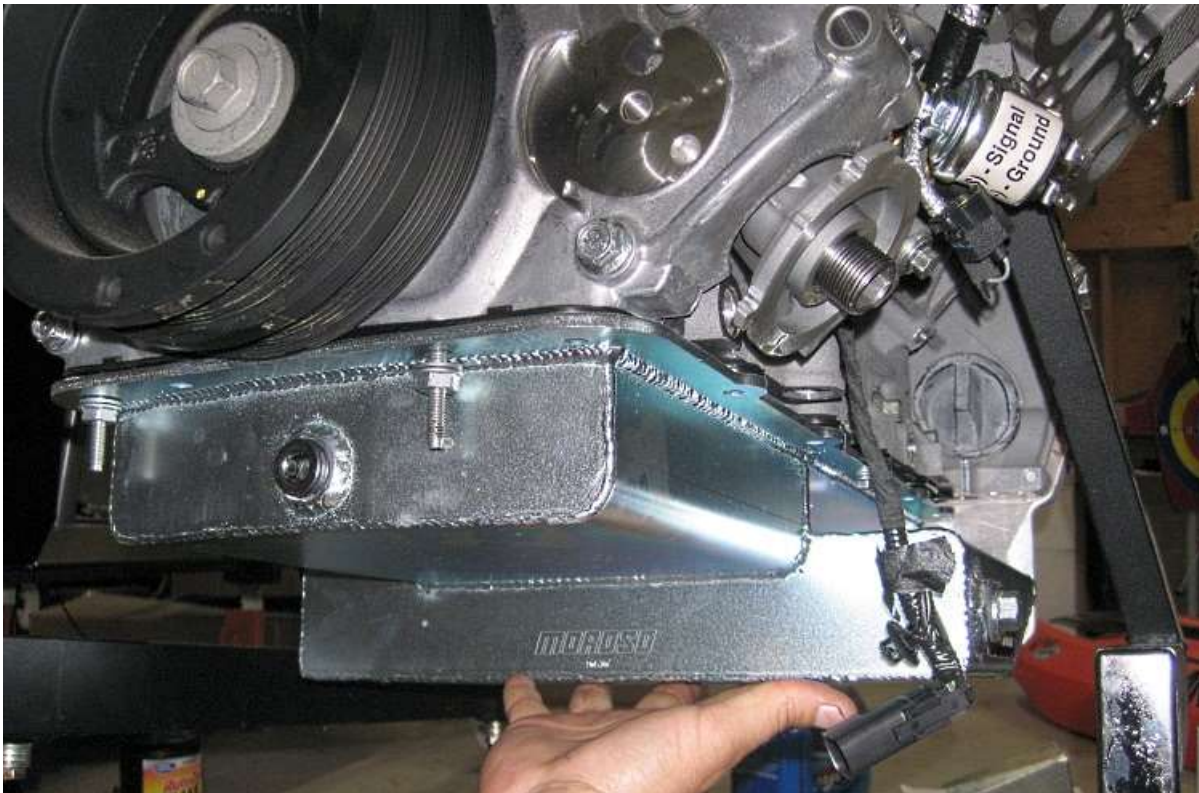

Hold the oil pan up to the block and thread all of the bolts in by hand.

Torque all of the accessible oil pan bolts to **10 Nm +45 deg.**





For the bolts over the oil pan bump outs, use a wrench. Get the “feel” of the 10Nm by using the wrench on one of the correctly torqued bolts first then try to match this on the bolts not torqued.



Leave the wire harness sitting on top of the oil pan.

Engine mounts

-  Engine mounts, Engine mount spacers, M10 x 25mm bolts, $\frac{3}{8}$ " x 1.50" carriage bolts
-  $\frac{9}{16}$ ", 17mm sockets, ratchet, hammer.

Use a $\frac{9}{16}$ " socket and ratchet to remove the three locknuts on each of the engine mounts and save them.
Use a hammer to remove the three carriage bolts from the bottom engine mount plates. They are not used again.

ITEM NO.	PART NUMBER	DESCRIPTION	QTY.
1	4.6L left side top mount		1
2	4.6L left side bottom mount		1
3	16249	COYOTE ENGINE MOUNT 2 HOLE SPACER	1
4	16250	COYOTE ENGINE MOUNT 1 HOLE SPACER	1
5	16251	COYOTE ENGINE MOUNT 3 HOLE SPACER	1
6	RHSSNBOLT 0.375-16x1.5x1-N		3
7	13964	NYLON INSERT LOCKNUT, 3/8-16 UNC	3
8	AM-M14-N		1

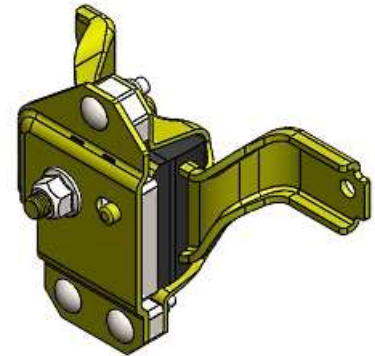
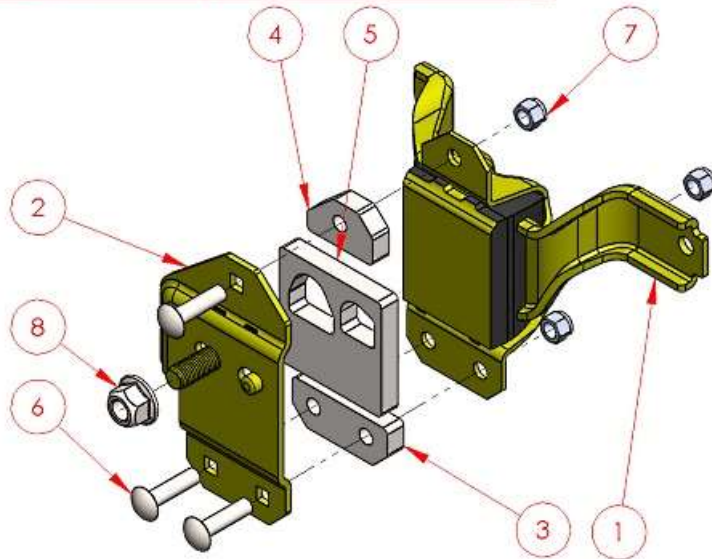

Reassemble the left engine mount using the 1/2" thick spacers, 3/8"x 1.50" carriage bolts and a 9/16" socket with ratchet. Reuse the 3/8" locknuts.

ITEM NO.	PART NUMBER	DESCRIPTION	QTY.
1	16249	COYOTE ENGINE MOUNT 2 HOLE SPACER	1
2	16250	COYOTE ENGINE MOUNT 1 HOLE SPACER	1
3	16251	COYOTE ENGINE MOUNT LARGE SPACER	1
4	4.6L right side bottom mount		1
5	4.6L right side top mount		1
6	AM-M14-N		1
7	RHSNBOLT 0.375-16x1.5x1-N	16264	3
8	13964	NYLON INSERT LOCKNUT, 3/8-16 UNC	3

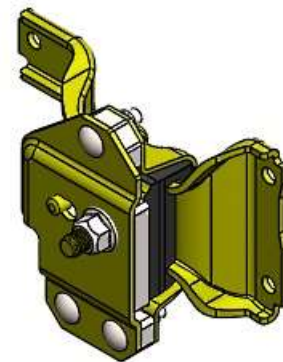
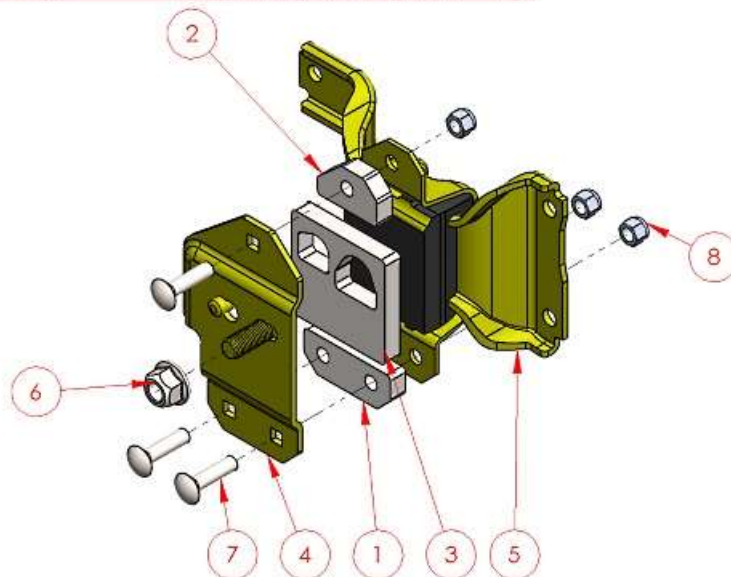

Reassemble the left engine mount using the 1/2" thick spacers, 3/8"x 1.50" carriage bolts and a 9/16" socket with ratchet. Reuse the 3/8" locknuts.



Attach the engine mounts to the engine using the M10 x 25mm bolts provided with the engine mounts and a 17mm socket with ratchet. Don't forget to attach the engine ground strap to a right side engine mount bolt.

Oil Pressure sender



Remove the stock oil pressure gauge sender plug from the block located on the left front side of the engine. This plug will not be used again



Place a bucket or container to catch oil under the filter and remove the oil filter. This filter is too long and will not be used again.



Use an H14 hex key to remove the oil filter nipple and cooler. These will not be used again.



Insert the AL3Z-6890-A oil filter nipple.



Use the H14 hex key to tighten the nipple in the block.



The oil pressure sender will get installed after the water temp sender is installed.

Water Temp Sender



H14 Hex key or socket, 1 $\frac{1}{16}$ " socket, $\frac{7}{8}$ ", 12mm deep socket, extension, ratchet, Teflon tape

Water temp gauge sending unit.

Autometer gauge sender shown, similar install for Vintage gauge sender.



Remove the $\frac{3}{4}$ " NPT plug from the side of the block using a H14 Hex key.



Use Teflon tape on the $\frac{1}{8}$ " NPT to $\frac{1}{2}$ " NPT adapter included with the gauge.



Use a vise to hold the large $\frac{3}{4}$ " to $\frac{1}{2}$ " NPT adapter then use a $\frac{7}{8}$ " wrench to put the two adapters together.



Screw the adapter into the block using a 1 1/16" socket.



Screw the adapter into the larger adapter on the block.



Put Teflon tape on the sending unit Autometer top, Vintage bottom



wrench to screw the sender into the adapters.

Oil pressure sender



Screw the oil pressure sender and adapter into the block and tighten.

Transmission Prep

- ✂ Hack saw or Reciprocating saw, $\frac{3}{4}$ " socket, ratchet
- 🚗 Transmission, Polyurethane engine/transmission mount kit
- 👤 The two aluminum spacers provides are not used.
- 👤 The FFR Coupe **does not** need the boss cut off the transmission.



If you are using a Tremec 3550, TKO 500 or, a TKO 600 you will need to trim off the unused mounting boss on the bottom of the case.



Trim it flush or just below the pad for the transmission mount.

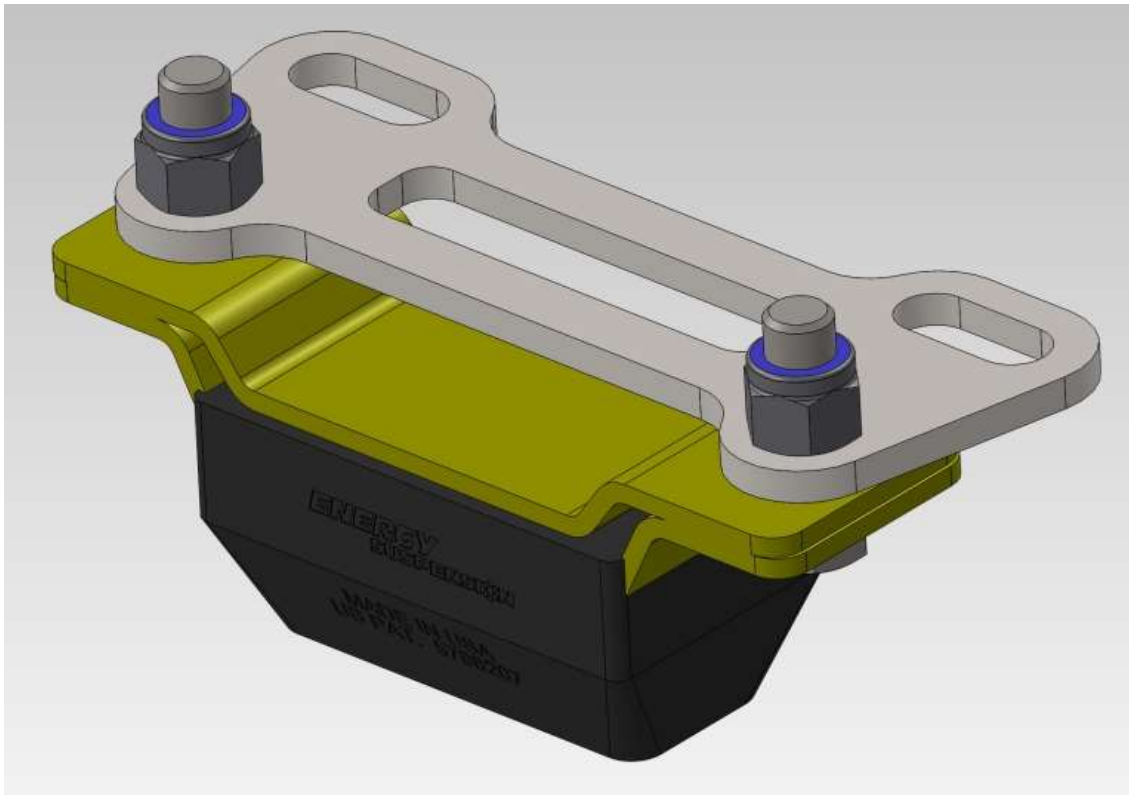

Attach the transmission mount plate to the polyurethane transmission mount using the ½"-13 x 1.50" bolts.

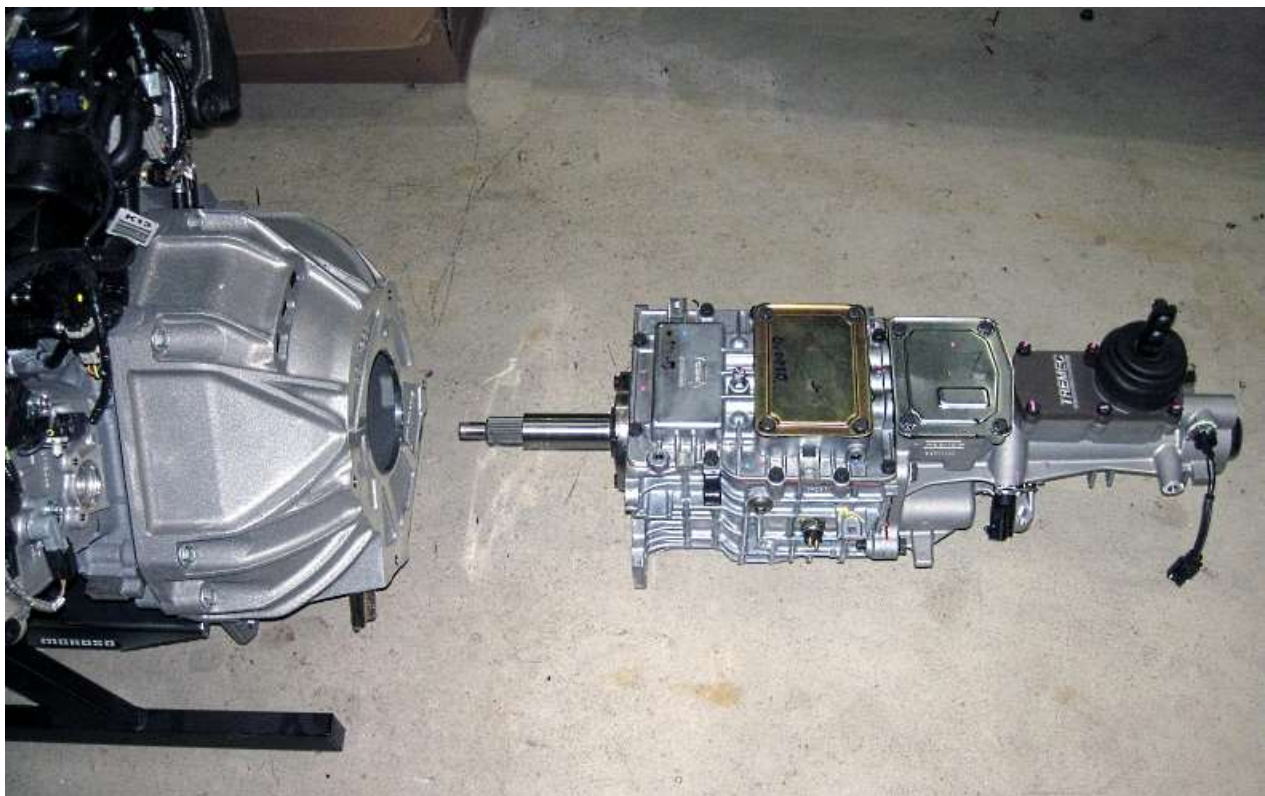

Attach the transmission to the bellhousing. Torque the bolts to **50lbft**.

Engine/Transmission Installation

Install the engine and transmission per the assembly manual.



The engine will sit low in the engine mounts.



Attach the polyurethane transmission mount assembly to the transmission.

Attach the polyurethane transmission mount to the frame mount.

Alternator

Install the Ford Racing alternator and tensioner per the Ford Performance instructions

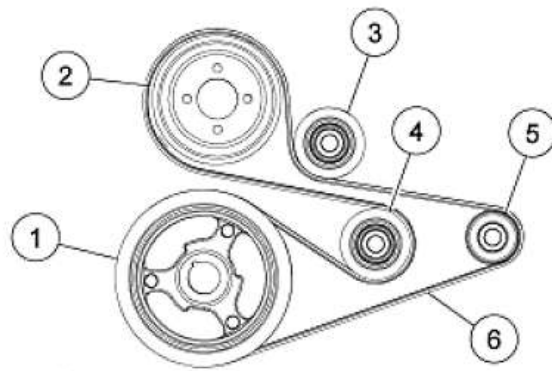

Item	Description
1	Crankshaft pulley (on engine)
2	Coolant pump pulley (on engine)
3	Accessory drive belt idler pulley (on engine)
4	Accessory drive belt tensioner pulley
5	Alternator and pulley
6	Accessory drive belt

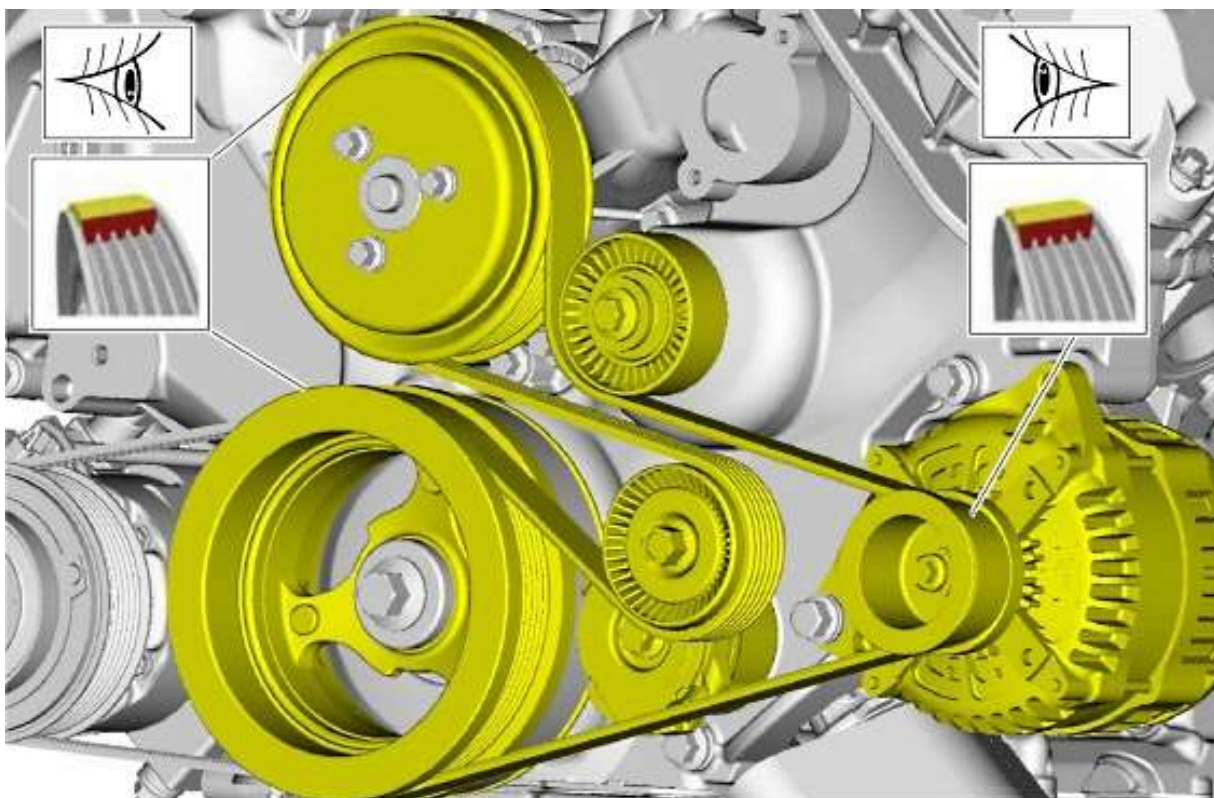

Route and install the serpentine belt.

Remove the stock oil pan and install a shallow oil pan.



On the left side of the engine, remove the wiring harness holder from the stud on the front of the head; it will hit the steering shaft after install.

Shifter handle





Sit in the driver seat and decide how you want to hold and shift the shifter handle, we have found that with the Coyote transmission location a vertical shifter works better.



Drill a hole above the bottom hole on the handle. Start with a small bit and work your way up. The handle is forged so it is hard and will take a while.

The handle usually gets final mounted after the carpet is installed.

Fuel System

-  Fuel pressure regulator, fittings, fuel hose, hose clamps, high pressure fuel pump
-  The Coyote engine requires a 255 lph high pressure fuel pump such as the Summit Racing SUM-G3138 Fuel Pump. Either an inline pump or in-tank pump can be used depending on preference.
-  Factory Five offers a complete fuel system for the Coyote including AN fuel lines, fittings, regulator and charcoal canister.

Fuel lines

Push the white fuel line connector onto the fuel rail.

Hold the fuel line up to the connector and cut it to length with a razor knife.

Remove the fuel line connector.

Slide a hose clamp onto the hose then push the fuel line connector into the hose and tighten the clamp.



Push the white connector onto the fuel rail.

Fuel pressure regulator vacuum

Cut a 2.50" section from the length of 1/2" hose provided.



Assemble the 1/2" to 5/32" 90 degree adapter.

Push the ½" side into the short section of ½" hose and fasten with a hose clamp.
Slide a second hose clamp onto the hose.
Push the vacuum line onto the hose adapter.



Push the ½" hose onto the vacuum port on the right side of the throttle body so the small end points towards the firewall and tighten the hose clamp.



Run the vacuum line to the fuel pressure regulator and push it onto vacuum barb.

Cooling system

- ✂ Razor knife, flat head screwdriver, wire cutters, hack saw, marker, $\frac{5}{16}$ " socket, ratchet.
- 🚗 Stainless radiator hose kit

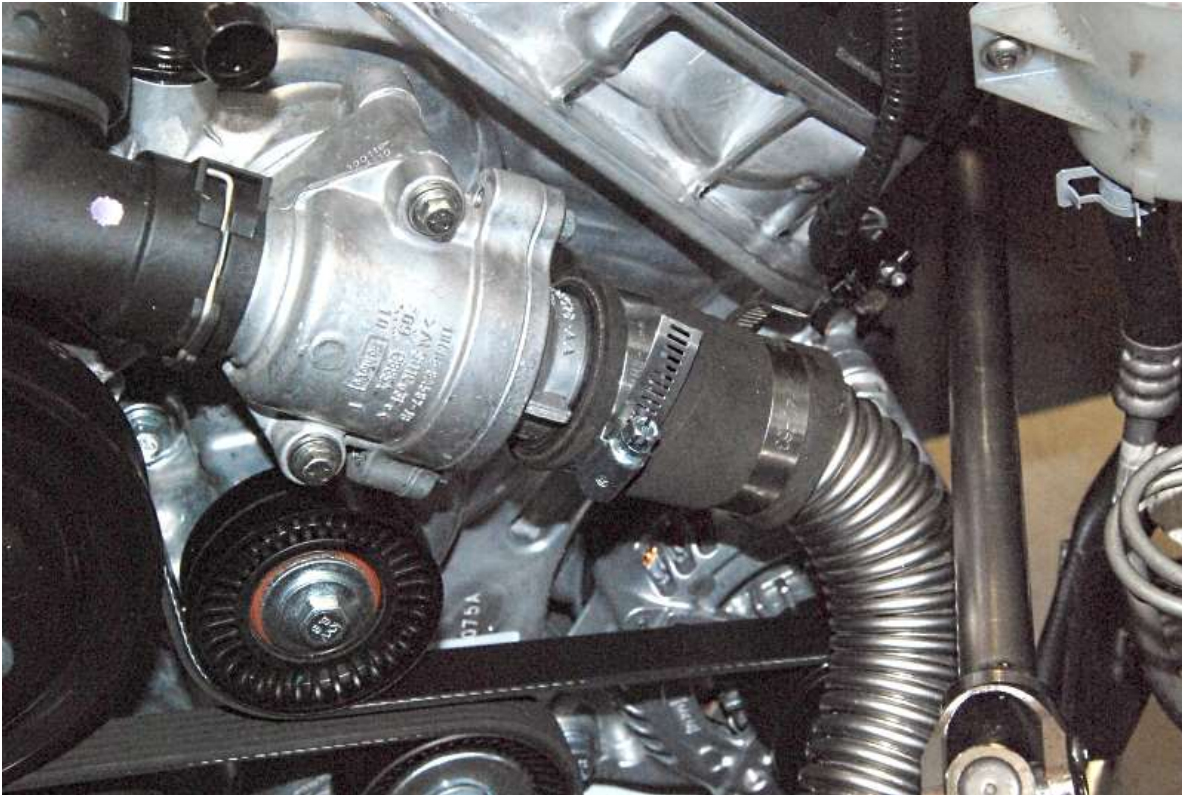

Push the correct size adapters onto to the thermostat housing with a length of the stainless hose.

Route the stainless hose to the left side lower radiator outlet and mark the hose for cutting.
Remove the stainless hose and cut it where marked with a hack saw.
Reinstall the hose.



Push the Ford supplied hose onto the outlet under the throttle body.



Decide where you would like to change to the stainless hose and cut the webbing off the hose using wire cutters.

Cut the hose using a razor knife.



Push the stainless hose into the end of the rubber hose and run the hose to the right side upper radiator inlet.



Push and hose clamp the small coolant barb behind the 3/4" coolant tubes.

HEATER CORE BYPASS HOSE

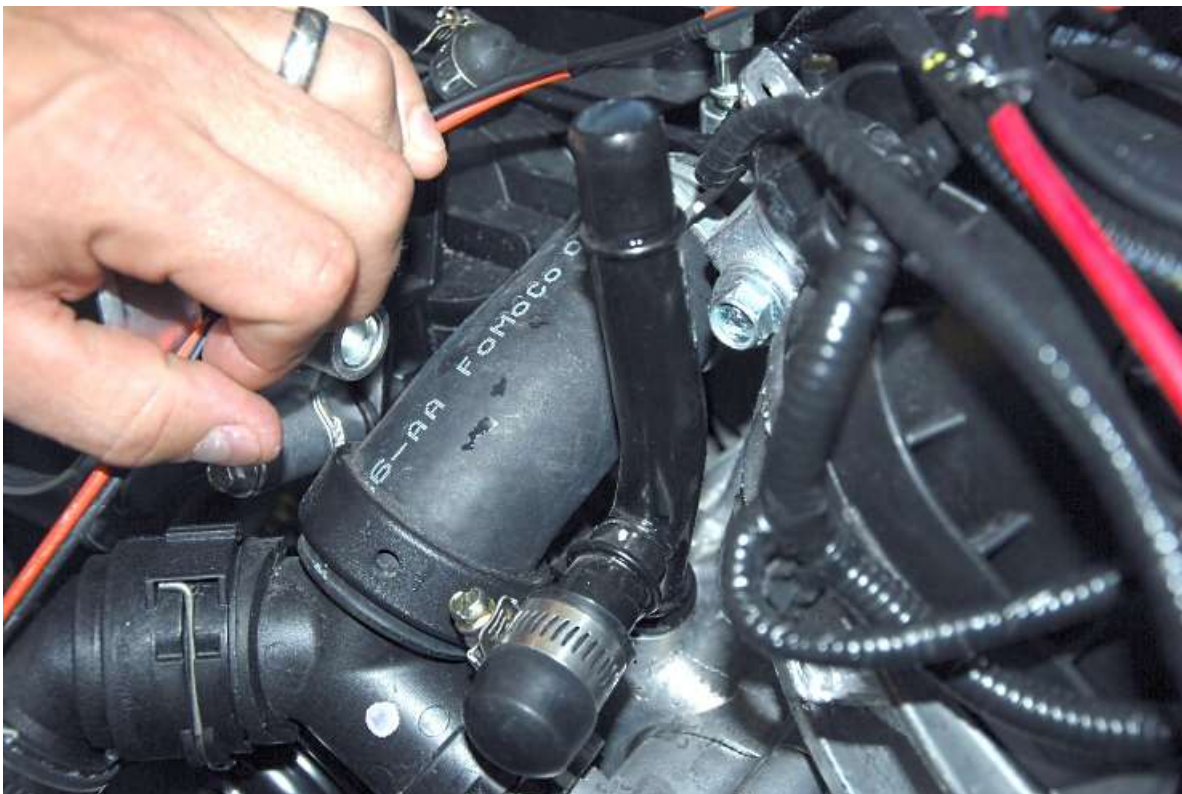

Push the bypass caps onto the lower tube to the left of the throttle body and hose clamp it.



If running a heater or A/C, do not push the spacer into the tube in the next step.



If running a heater or A/C, this is the tube that the heater core would get plumbed into.

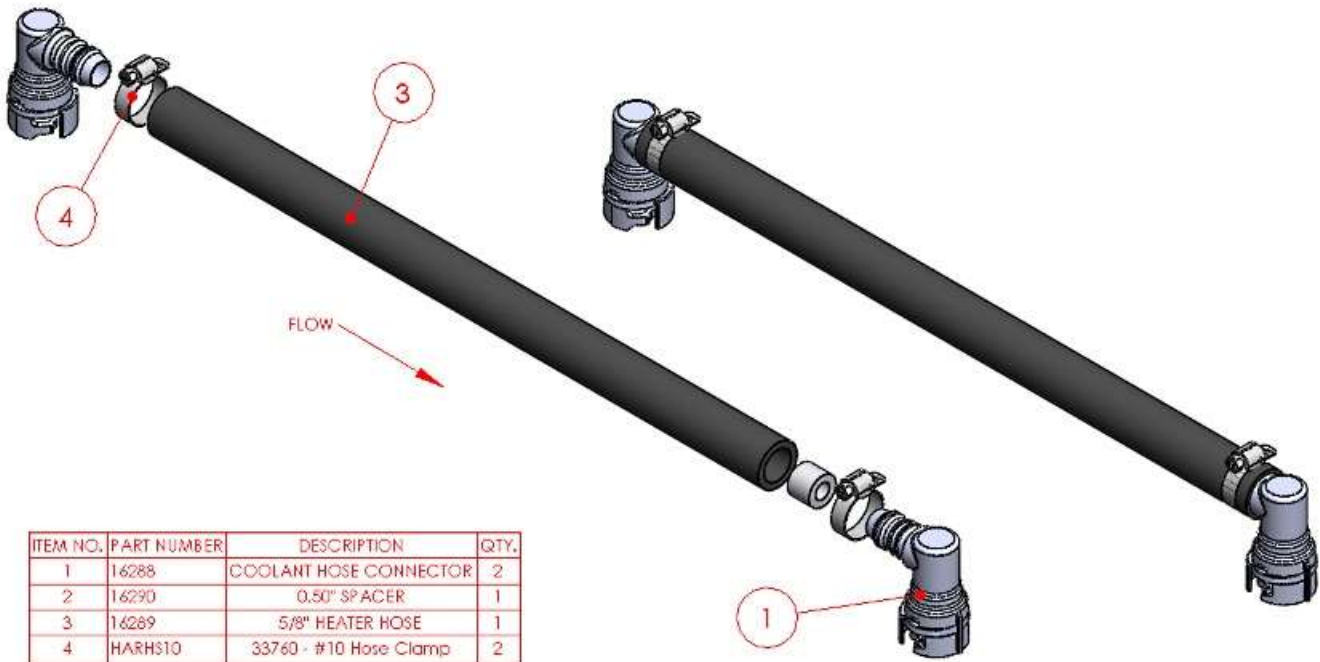

ITEM NO.	PART NUMBER	DESCRIPTION	QTY.
1	16288	COOLANT HOSE CONNECTOR	2
2	16290	0.50" SPACER	1
3	16289	5/8" HEATER HOSE	1
4	HARHS10	33760 - #10 Hose Clamp	2

Assemble the right side of the heater bypass hose, insert the 0.50" aluminum spacer into the 5/8" heater hose followed by a hose clamp then push one of the 90° plastic coolant hose adapters.

Tighten the hose clamp using a 5/16" socket and ratchet.



Push the hose onto the top of the tube to the left of the throttle body.

Push the other adapter onto the tube on the right side of the intake then measure and cut the 5/8" heater hose so that it will connect to the adapter and route where desired.



Put a hose clamp on the hose, push it onto the coolant adapter and tighten the hose clamp.

✎ For air bleeding later, remove the 90° plastic coolant hose adapter to the left of the throttle body until coolant starts going up the tube then recap and hose clamp.

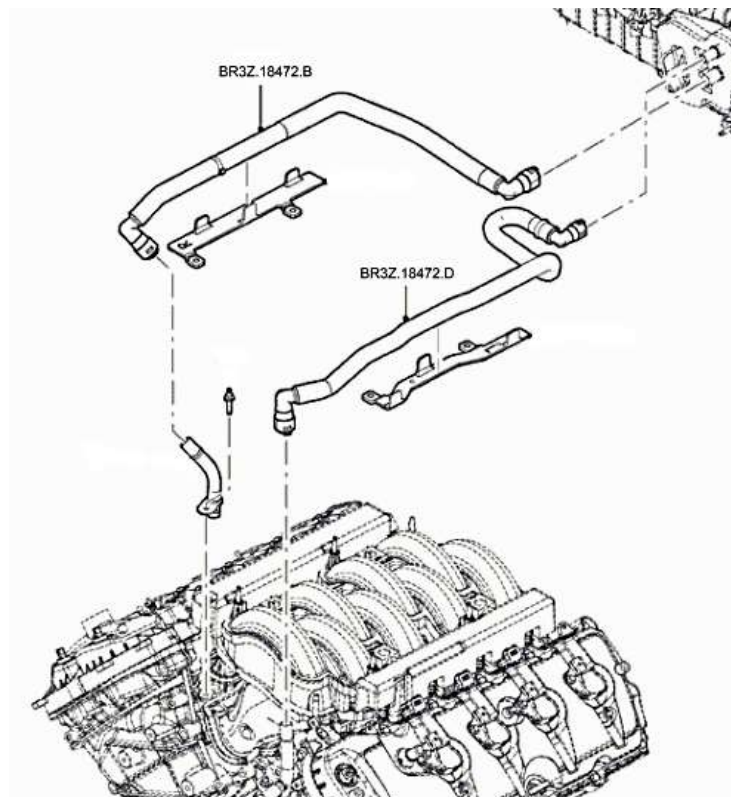

✎ If running a heater, use the bypass hose connectors and some heater hose to connect to the heater.

Air Intake

Mass Air Meter



Mass air meter, silicone hoses, intake tubes, air filter



T-20 Torx driver, Flat head screwdriver, Philips head screwdriver, sensor safe RTV silicone



There are two different ways to do this Spectre or Treadstone



Unscrew the mass air sensor from the Ford intake using a T-20 Torx driver



Remove the sensor and note the direction of the curved part of the sensor.

SPECTRE ASSEMBLY



Install the rubber ring into the intake mount.

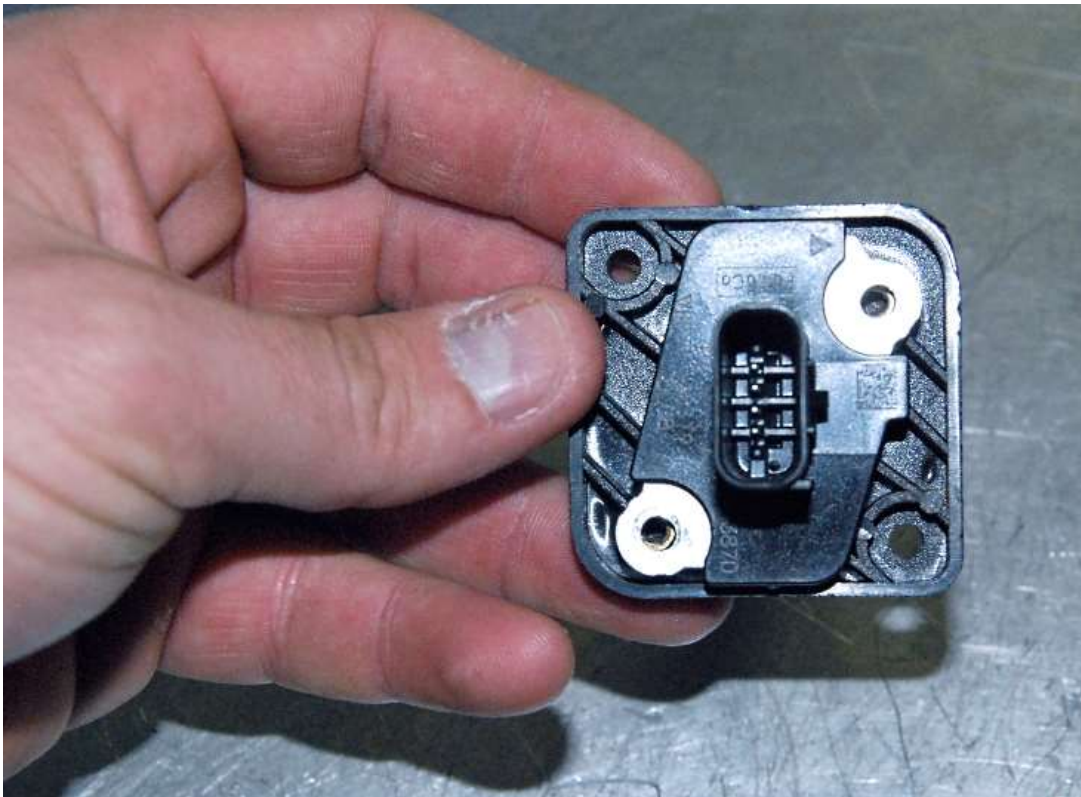

Insert the sensor into the mount to determine which way around it needs to go so the sensor mount holes will line up and the sensor will mount the correct way.



Attach the mount to the intake tube using the long screws so that the flat side of the sensor will face the "Spectre" writing.

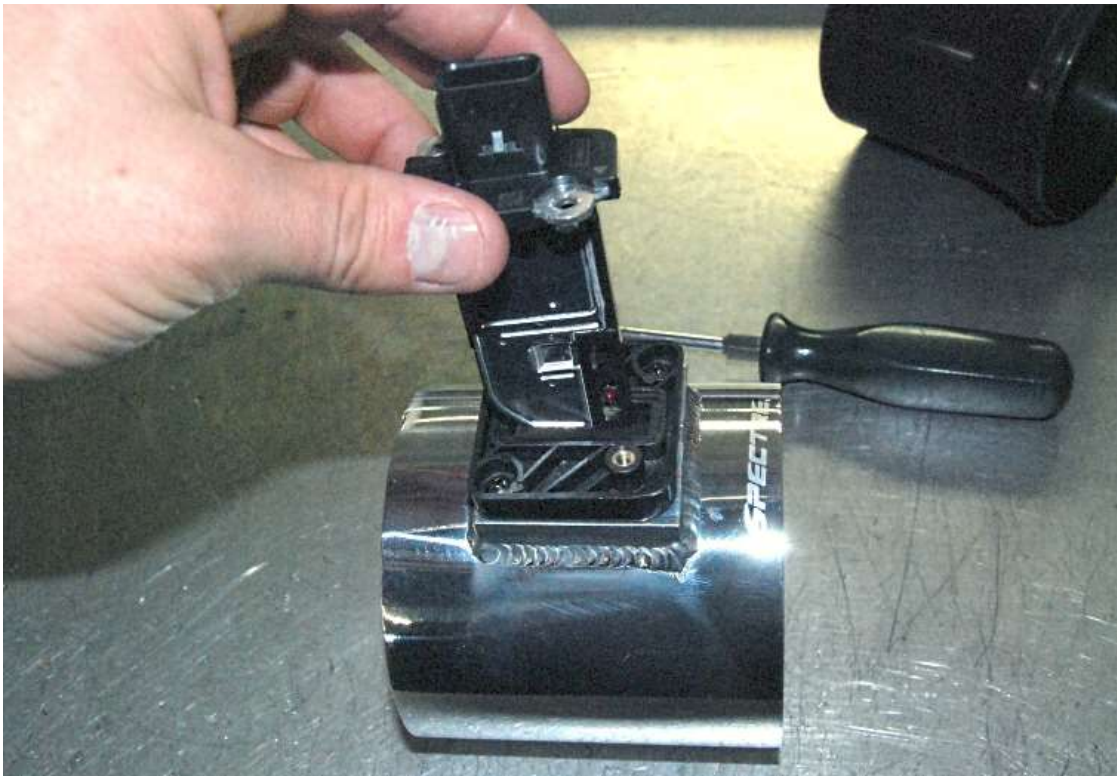

Install the sensor on the mount using the short screws so the flat side of the sensor will face the “Spectre” writing.



Run a bead of Sensor safe RTV silicone around the flange of the large plastic reducer.



Slide the Mass Air Meter tube flat sensor side first (Spectre writing) down onto the plastic reducer.

Wipe any excess RTV off the tube.



Turn the mass air meter over so the Reducer is on the top and let the RTV dry overnight.

Intake tube

SPECTRE MAF SENSOR



Slide the Mass Air Meter tube flat sensor side first (Spectre writing) into the air filter.

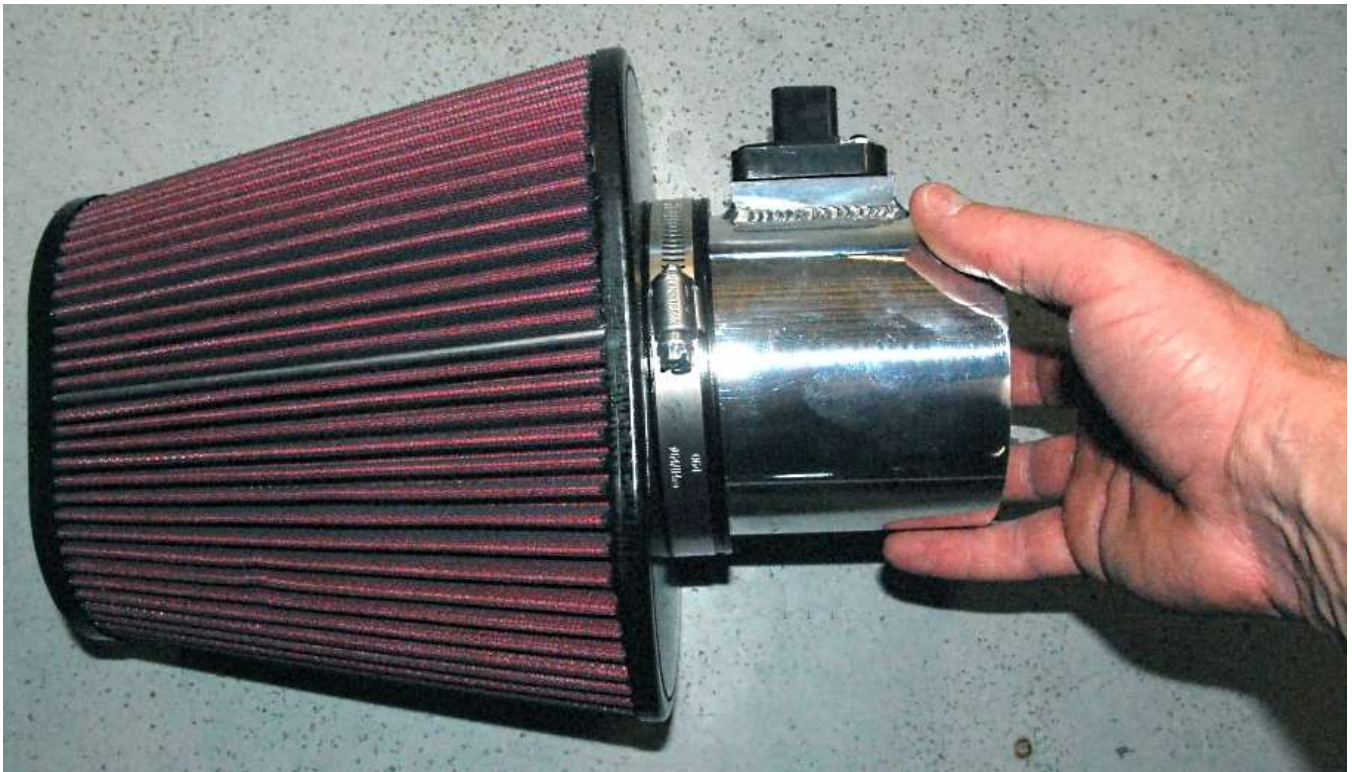

Adjust the Mass air meter so that the mass air plug is on the far side as the Ford Racing instructions recommend.



Tighten the hose clamp.

Connect the elbow tube to the mass air meter using the silicone connector; only tighten one of the hose clamps right now.

Attach the silicone reducer to the tube elbow.

Push the intake tube onto the throttle body and position the air filter under the hood hinge. Tighten the hose clamps.



TREADSTONE MAF SENSOR



Make sure the Mass Air meter is pointed in the correct direction.



Push the FFR filter onto the Mass Air meter making sure that the meter is facing the correct direction.

Slide hose clamps onto the 90° Silicone hose.



Test fit the 90° Silicone hose on the mass air meter and the throttle body.

Adjust the Mass air meter so that the mass air plug is on the far side as the Ford Performance instructions recommend.

Tighten the hose clamps



Push the mass air plug onto the mass air meter.

Vacuum ports and PCV vent

- ✂ Flat head screwdriver, razor knife, WD40
- 🚗 Vacuum plugs, PCV lines, ½” rubber hose, T connector



Block off the vacuum ports and fuel evaporator intake tube just behind the throttle body.

Valve cover hoses



If not already done, connect the right side stock PCV hose from the valve cover to behind the throttle body.



Attach the fitting to the left side valve cover.





Attach the other end of hose to the intake hose.

CMVV Vacuum hose



Attach the CMVV vacuum connector to the bottom fitting on the intake hose.

Clutch position switch

-  Ford Performance bottom travel switch, coyote clutch switch components.
-  $\frac{1}{2}$ " , $\frac{9}{16}$ " wrench, $\frac{1}{2}$ " socket, Ratchet, $\frac{3}{16}$ " , $\frac{5}{16}$ " hex keys.
-  The install is shown outside the footbox for better pictures.

Remove the clutch cable from the quadrant.

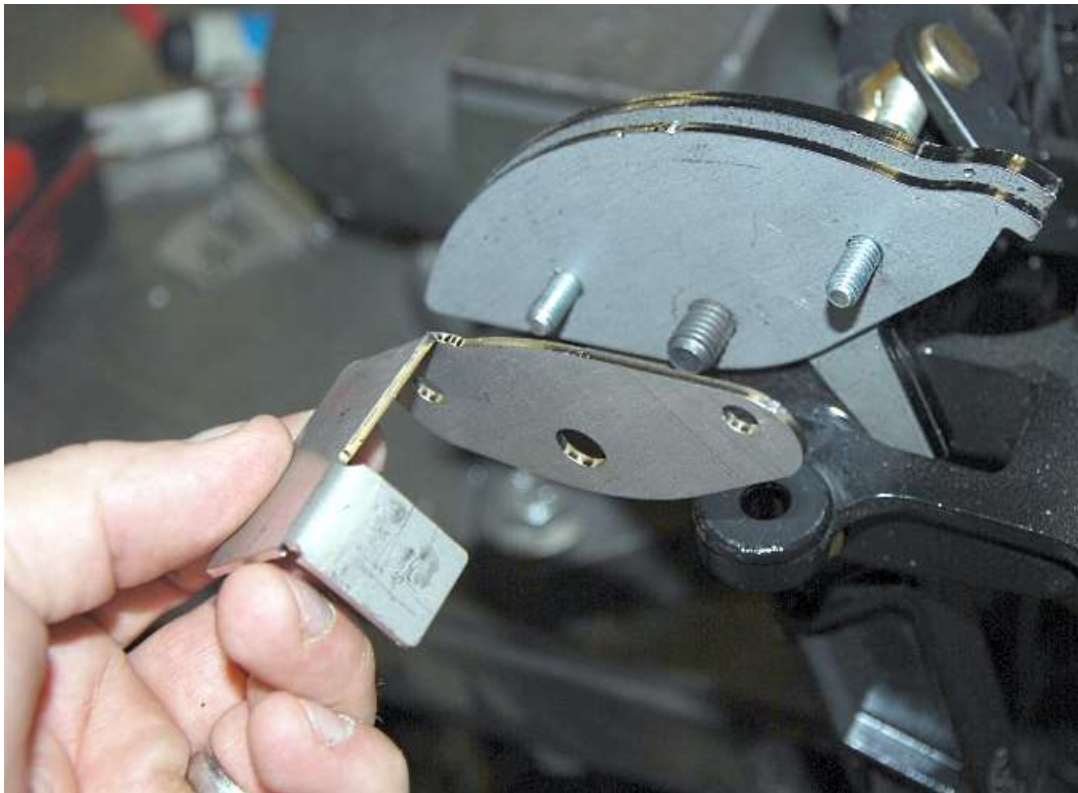

On the clutch pedal, remove the last $\frac{1}{8}$ " clutch quadrant end plate and replace it with the stainless bottom switch clutch quadrant plate.



Tighten the locknuts.

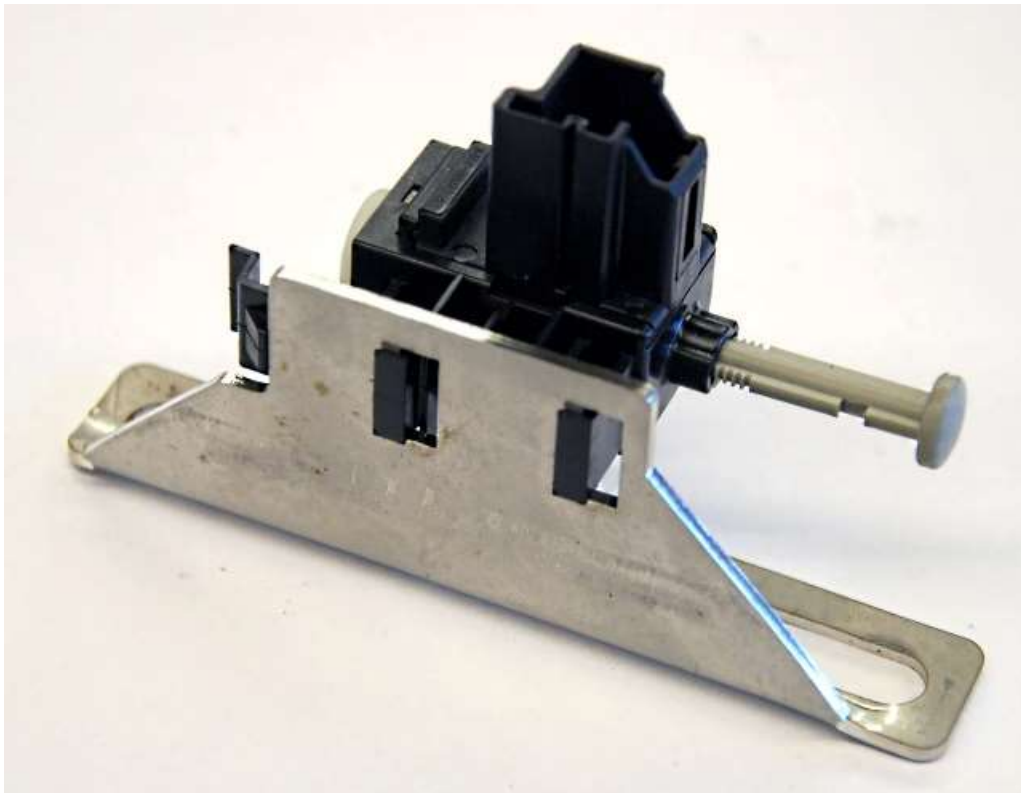

Attach the Bottom travel (gray plunger) clutch switch to the bottom travel switch mount as shown.

Remove the bolts holding the left side of the pedal box to the mount bracket.

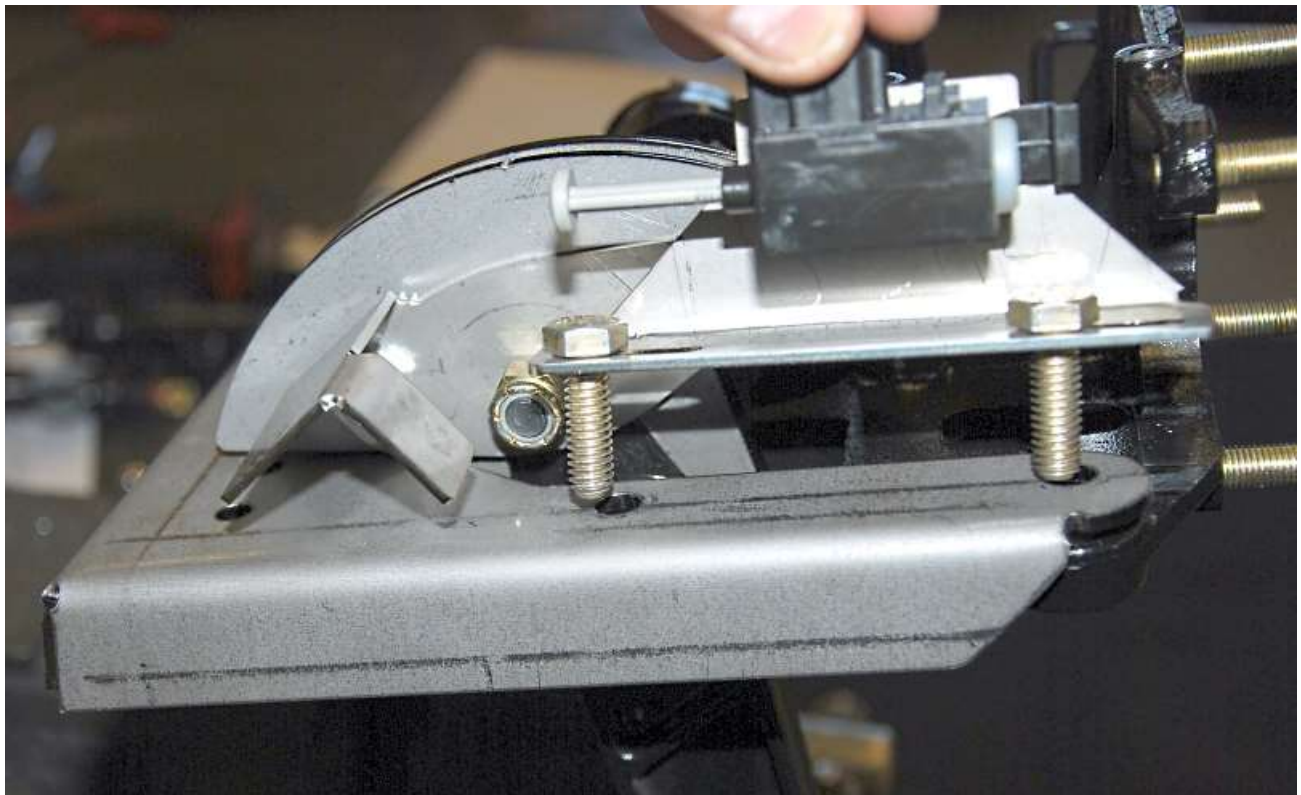

Insert the new $\frac{5}{16}$ " x 1.25" bolts through the bottom travel switch mount then through the pedal box bracket and pedal box.

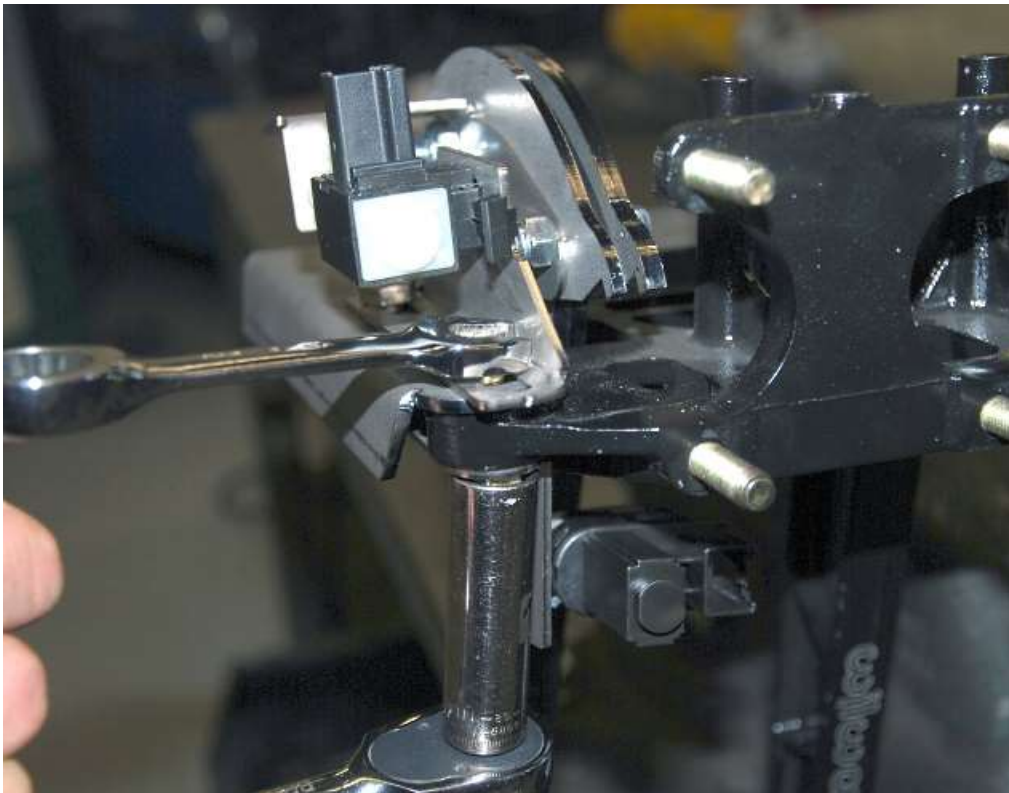

Snug the bolts up with a 1/2" wrench and socket so the bottom travel switch bracket can still move.

Reattach the clutch cable to the quadrant.

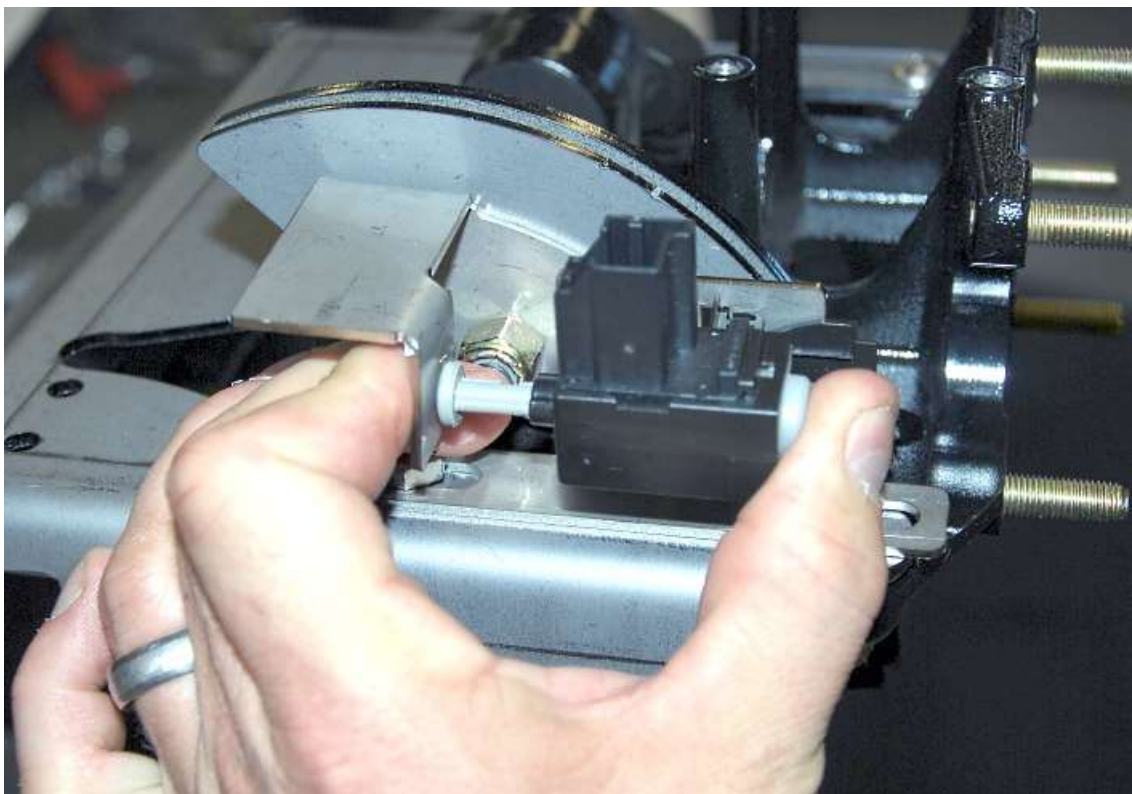

Have someone push the clutch pedal all the way in then slide the bottom travel switch mount so that the bottom travel switch is pressed in all the way against the quadrant plate. Hold the switch mount so that it

does not move and let the clutch out then tighten the pedalbox mount screws with a ½” wrench and socket making sure the switch mount does not move.

Check the throw of the clutch pedal again carefully. The switch should get pressed in all the way but should not get pushed hard enough to stress/move the body of the switch.

Wiring

Computer mounting

- ☞ Aluminum computer mounting bracket, ⅜” rivets
- ✂ Drill, ¼” driver bit, ⅜” drill bit, rivet tool, ½” wrench, ratchet, ½” socket.

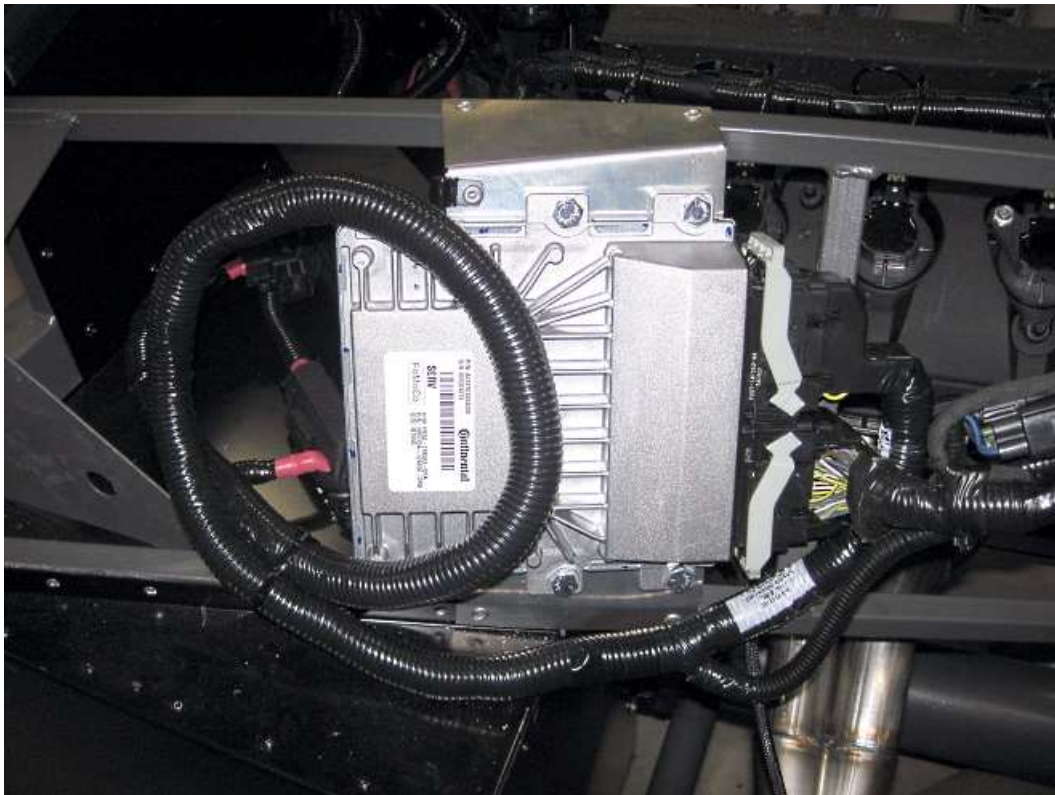

Locate the aluminum computer bracket so that it spans between the upper and lower ¾” tubes that go down to the front suspension on the right side of the chassis and the rear bottom computer hole lines up with the front of the right footbox.

Drill and rivet the bracket to the frame using the ⅜” rivets provided.

Attach the computer to the bracket using the ⅝”x 1.25” bolts and nuts provided along with a ½” wrench, ratchet, ½” socket.

Harness install

- ☞ Use the diagram at the beginning of these instructions for general routing and component location.

Lay the Control pack harness out on the chassis.



Use a 2.00" hole saw to cut a hole in the firewall just to the right of the dash support tube with the center 1.50" up from the 2" x 2" tube.



From the engine bay, push the harness leg with the grommet on through the firewall into the cockpit.

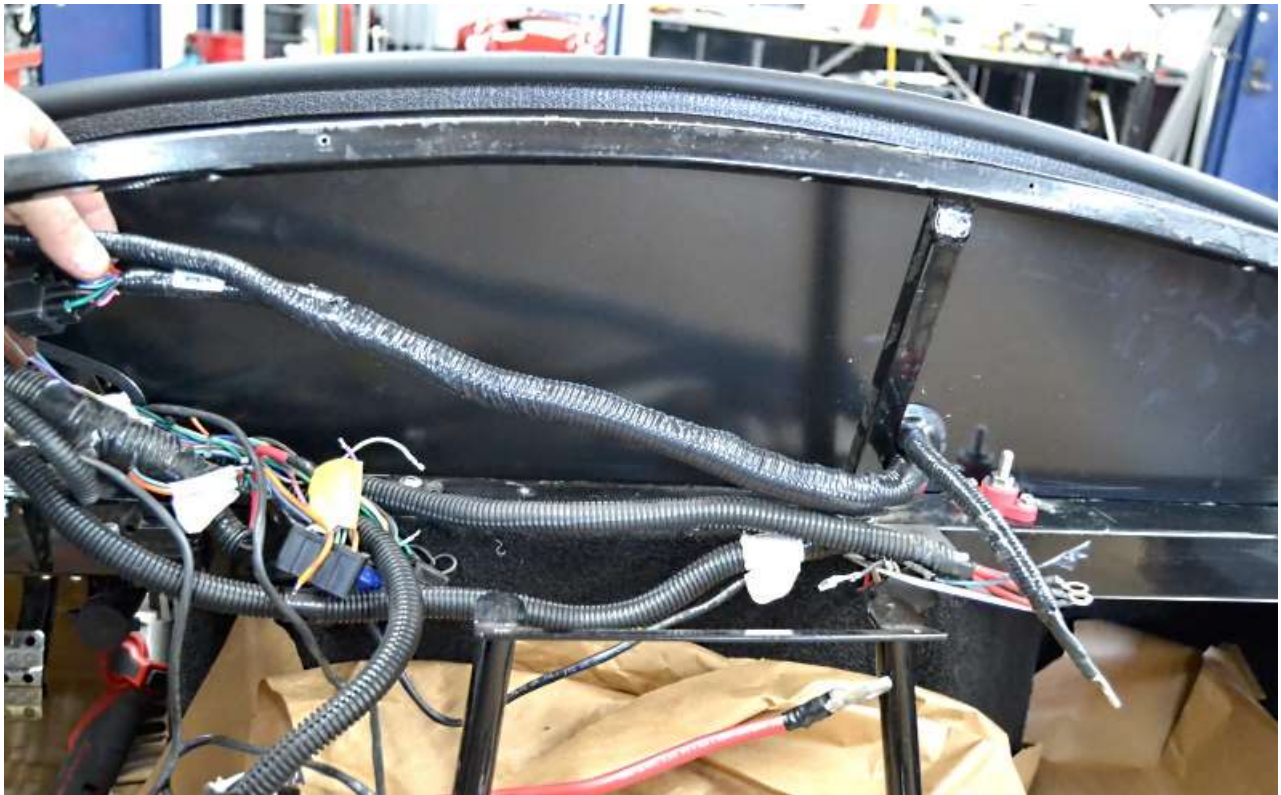

In the cockpit, run the wires across to the driver's footbox.



Connect the Accelerator pedal lead (APPS) to the pedal.



Connect the clutch pedal travel switch leads to the correct switches.

16-way Pigtail

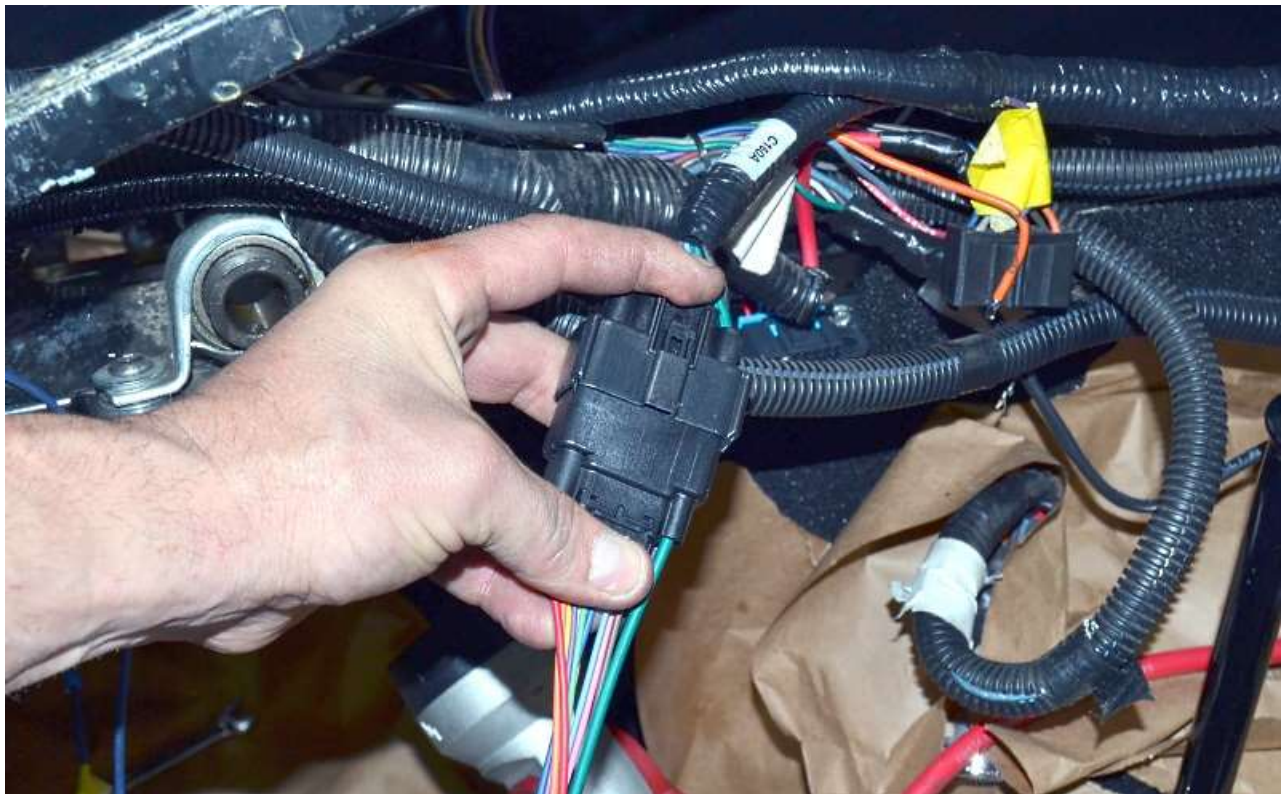

Connect the 16 way pigtail plug to the harness.

ENGINE BAY



Run the wires to the top of the right footbox. The other holes shown are: Right: rear and sending unit harnesses. Middle: Alternator and starter harnesses.



Locate the fuse panel mount (logo on it) and align the front edge with the kink in the right footbox.



Drill $\frac{3}{16}$ " holes through the footbox and use three of the $\frac{3}{16}$ " rivets to attach it to the footbox.



Attach the fuse panel to the mounting bracket using a $\frac{5}{32}$ " hex key, $\frac{7}{16}$ " wrench, $\frac{1}{4}$ " washer head screws and locknuts.

Connect the Engine harness plug and the Control pack plugs to the computer.

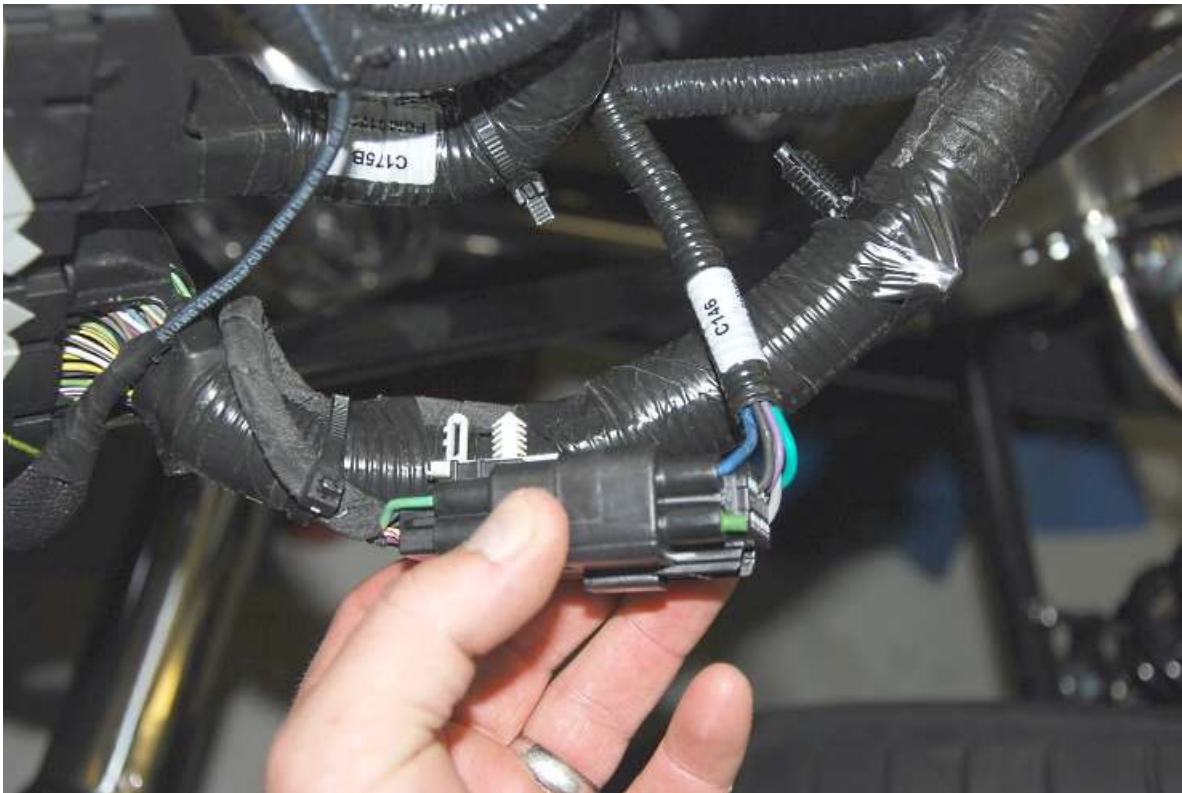

Connect the Engine harness plug to the control pack plug.

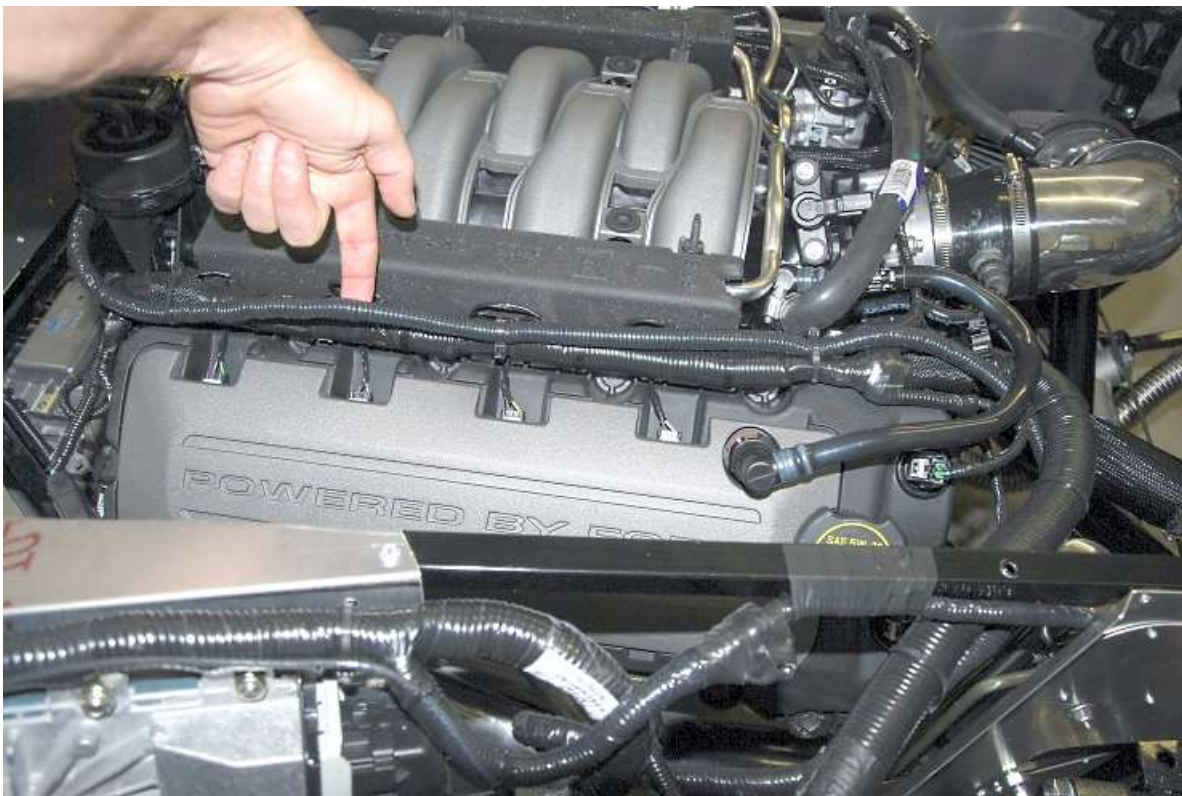

Run the BB harness leg to the back of the engine and across the back.



Run the BB harness leg back to the front of the engine on the left side.

Mass Air Meter



Plug the mass air meter connector into the mass air meter.

Alternator



Run the engine controls alternator plug down to the alternator.



At the back of the engine run the chassis harness alternator wire to the left side of the engine.



Run the chassis harness wires under the engine mount to keep them away from the header.

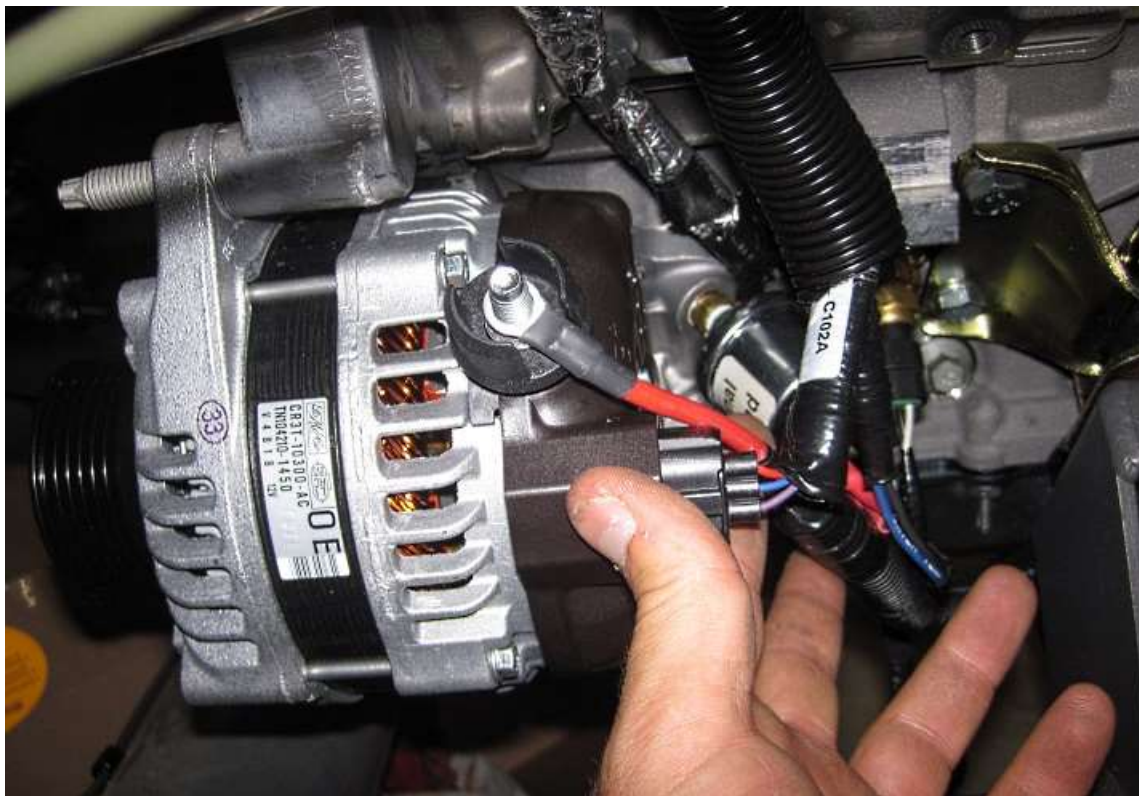

Attach the chassis harness alternator red wire to the post on the alternator.



Attach the engine harness alternator plug to the alternator.

Intercooler wire

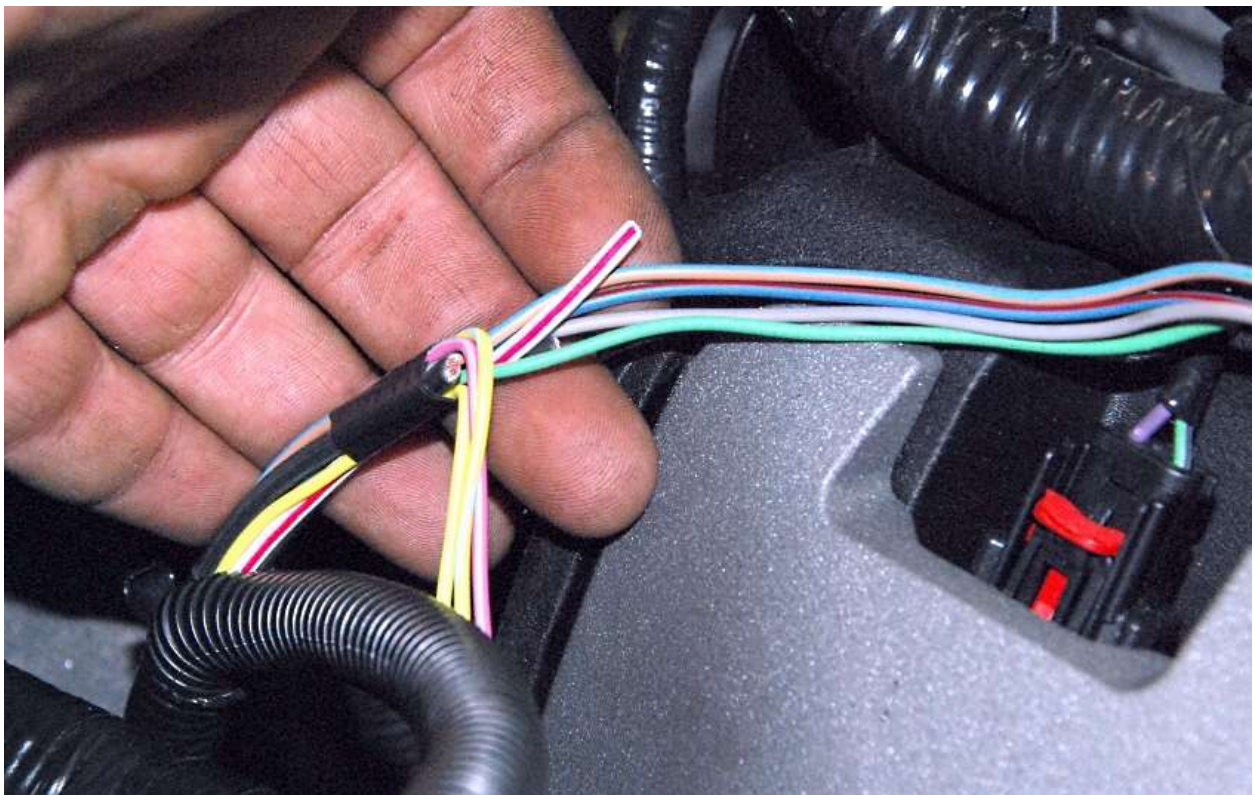

Cut the white/red Intercooler pump wire as far back in the harness as you can. It is not needed or used.

Radiator Cooling Fan

- It is best to let the engine control the radiator fan. If you do not want to do this, do not use the control pack wires and remove the correct radiator fan fuse from the black box.



From the computer area, run the harness with the orange fan wire forward to the fan and connect to the blue fan wire.

Ground the black fan wire.

Fuel Pump

- The fuel pump wire is in the Ford Performance 16 pin connector.
- This set-up allows the engine computer to control the fuel pump instead of the chassis harness but still uses the fuel inertia cut-off switch.

Route the Coyote harness fuel pump green wire to the back of the chassis harness fuse panel.

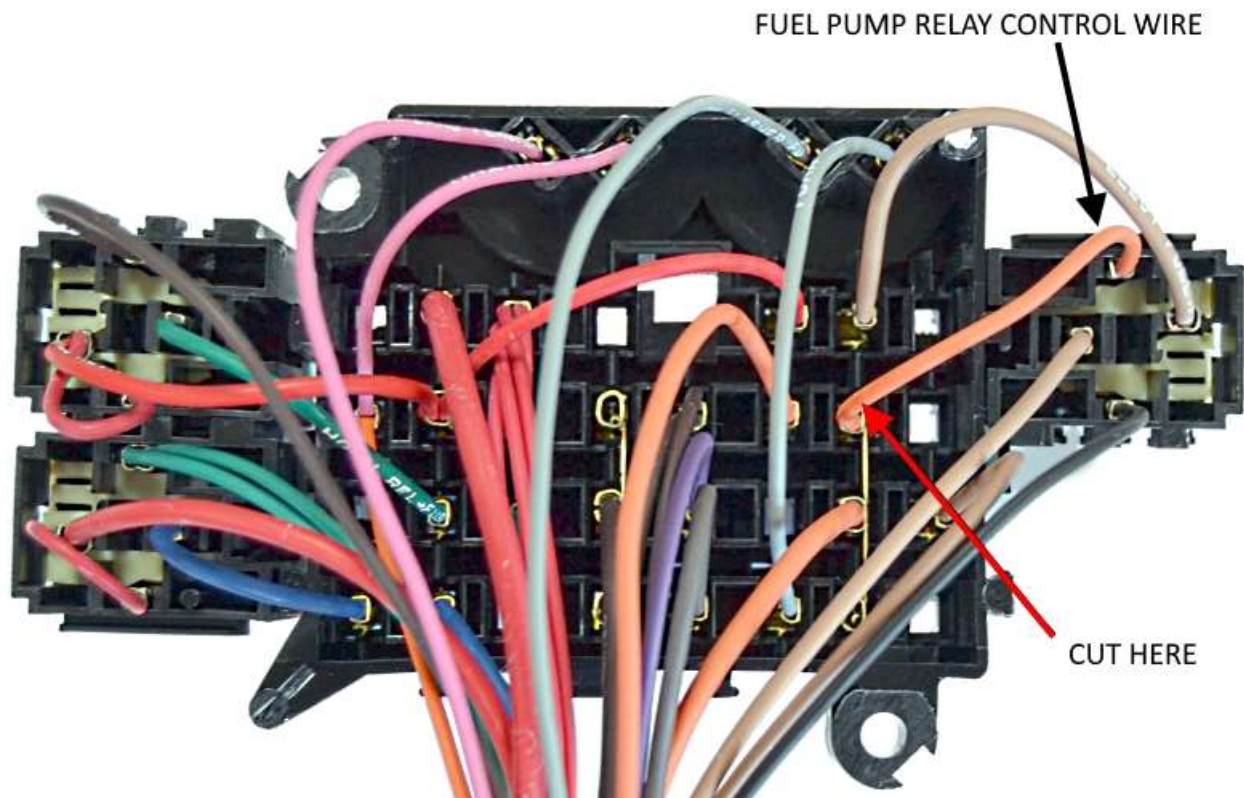

On the chassis harness, cut the small ORANGE jumper wire close to the buss bar that it jumpers from and connect the fuel pump wire from the EFI harness to the orange relay wire. This will use the EFI computer to turn the relay on/off.

The Inertia switch grounds the relay so this wiring still uses the inertia switch.



Solder and tape the green wire and Fuel pump relay wires together.

Make sure the wires and harness are out of the way of the steering shaft.

Battery power



Mount the inline fuse near the fuse panel using $\frac{3}{16}$ " rivets then run a battery cable from one side of the inline fuse to the fuse panel stud.

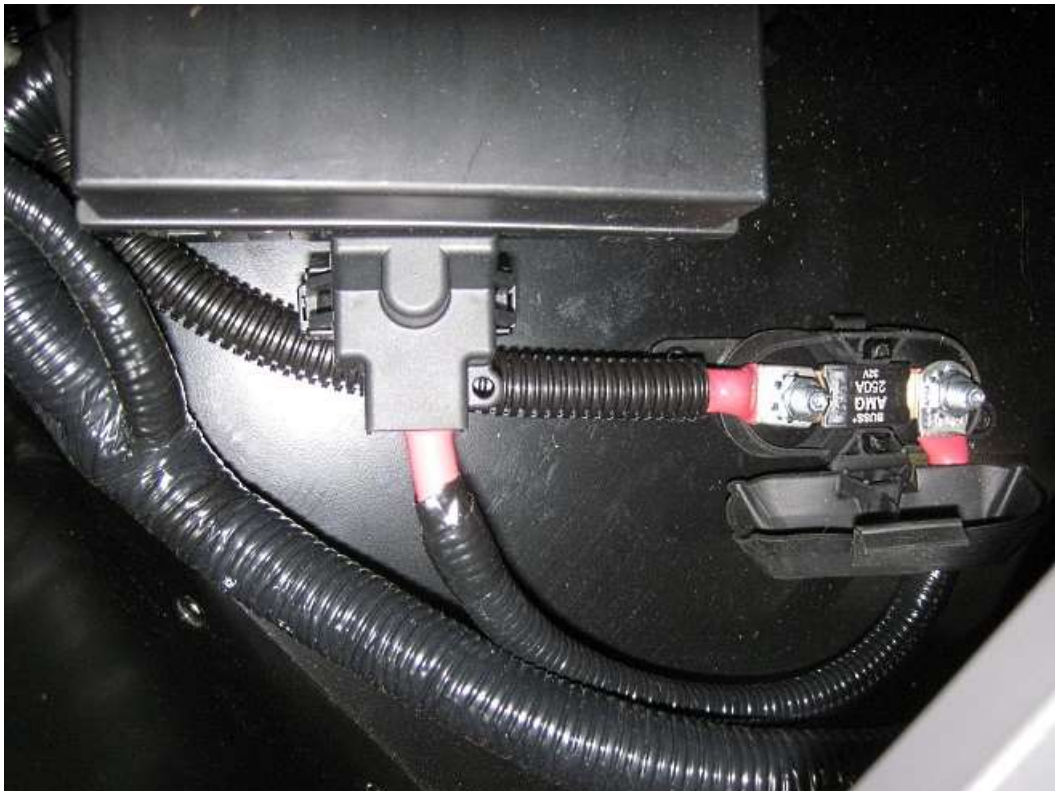

From the other inline fuse stud run a battery cable to the starter battery cable or to a battery cut-off switch.

Start power

✂ Soldering iron, wire cutters/strippers, electrical tape



Locate the EFI/crank and coil wires in the chassis harness.



Attach a ring connector to the black ground wire and ground it to the chassis.

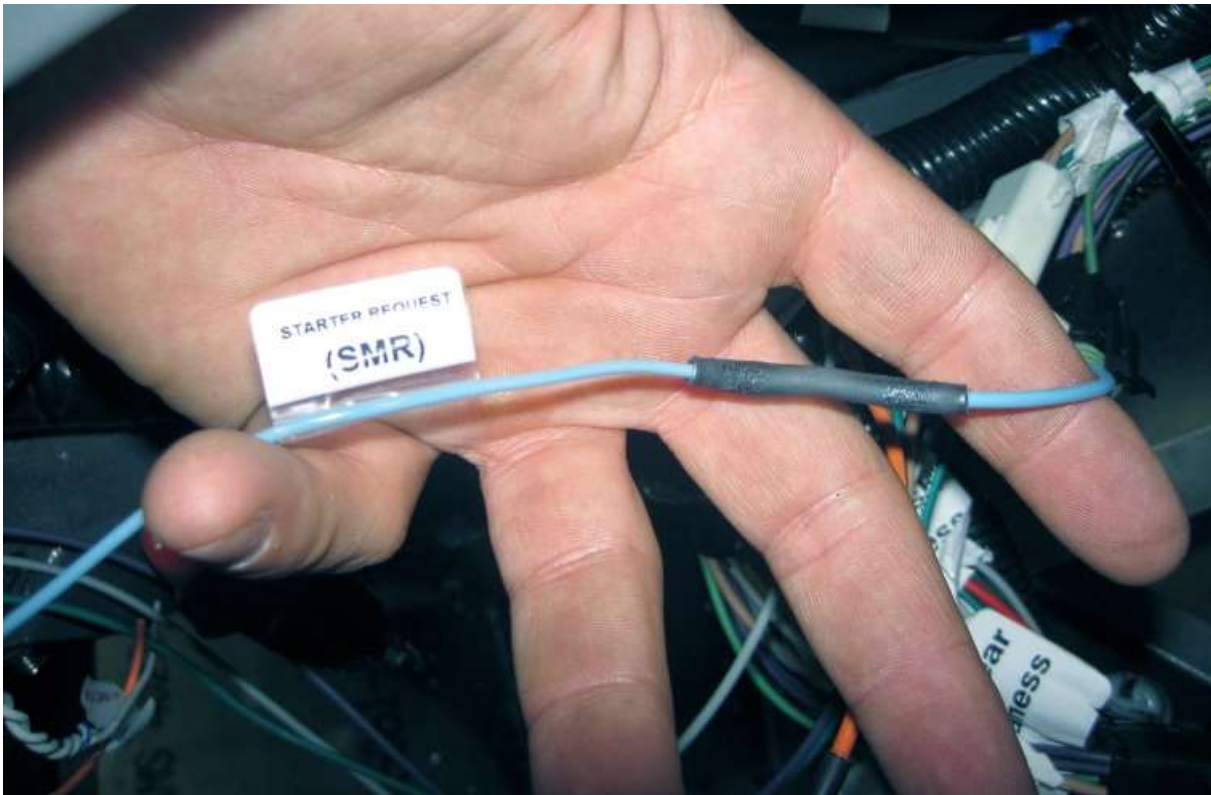

Attach the blue starter wire to the blue EFI wire in the harness.

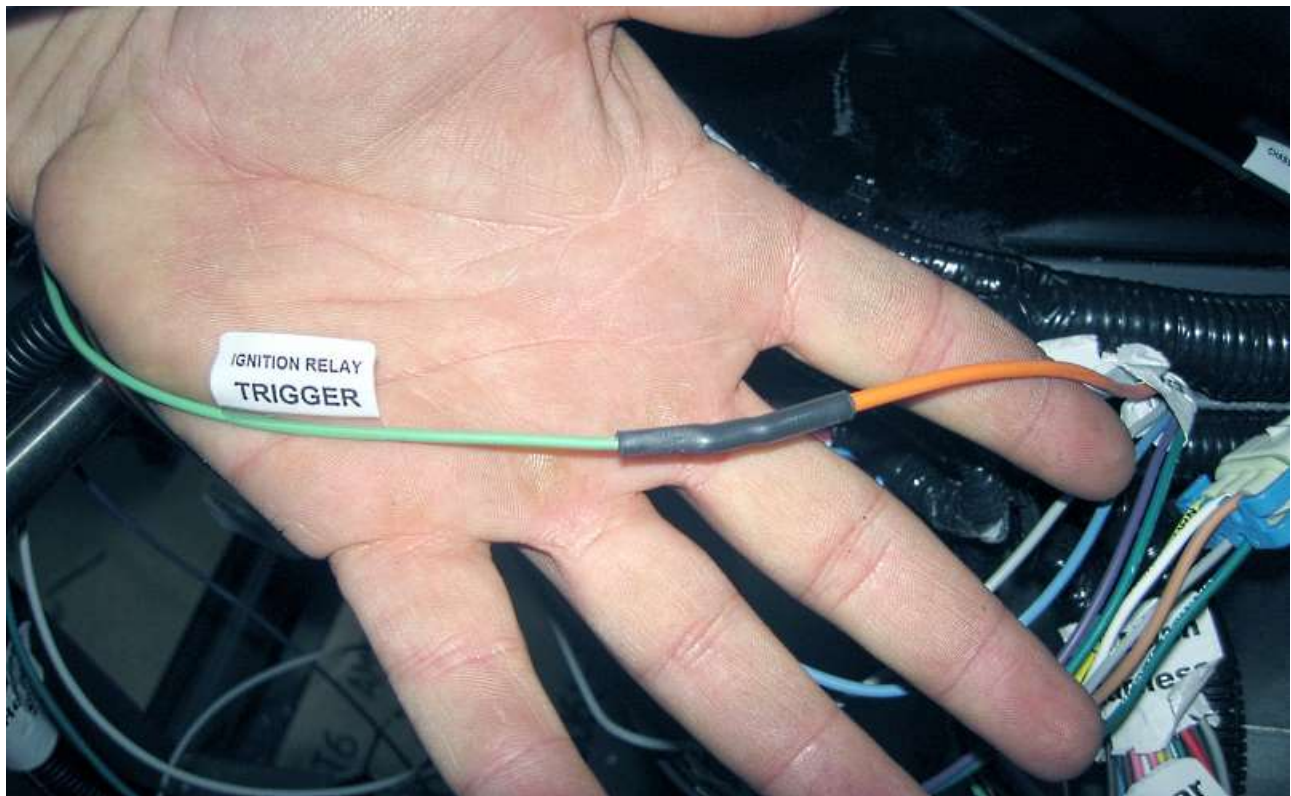

Attach the green ignition trigger wire to the orange EFI wire in the harness.



No other wires are used from the 16 way connector.

☞ We use the PCM engine starting directions in the Ford Performance instructions. This uses the engine harness starting wire to engage the starter.



Find the clutch safty switch wires in the left footbox.

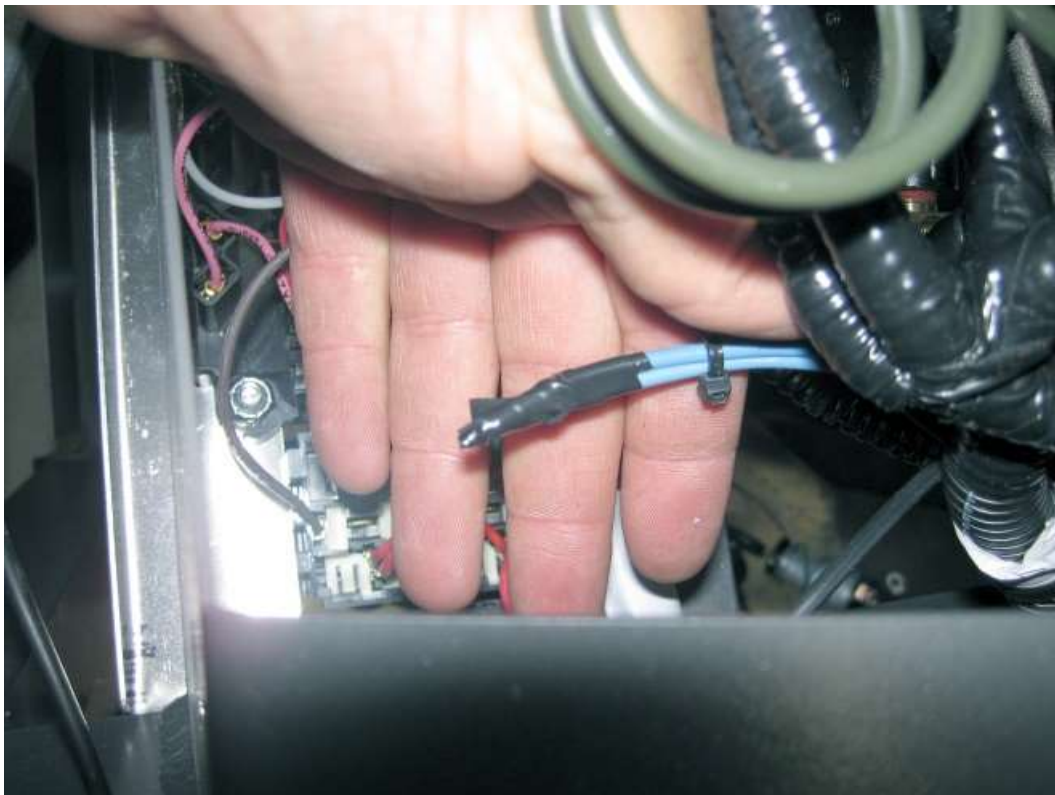

If a neutral safety switch is not going to be used, cut one of the two blue chassis harness wires slightly shorter than the other so the ends do not touch and electrical tape the end .



In the chassis harness on the starter wires leg, cut the blue starter wire end off.



Pull the loom back further down the leg then pull the blue wire out so it does not stick out for the harness and cut it off.



Electrical tape the end to the other wires.

Tach



Soldering iron, wire cutters/strippers, electrical tape.



There is no tach wire in the engine harness. The tach will need to get connected to a coil wire as shown in the gauge instructions according to the Type #3 Coil on plug description.



Run the sending unit harness along the lefttop side of the engine.



At the #4 cylinder, pull the chassis harness tach wire (purple) out of the harness and remove the tape covering the coil plug wires.



Use a razor knife and wire strippers to remove a short section of the wire insulation on the blue/red wire.



Solder the tach wire to the blue/red wire.



Wrap the connection in electrical tape.



Re-wrap the coil plug wires.

Oil Pressure and Water temp sensors



Continue the sending unit harness to the front of the engine.



Use some of the kit $\frac{3}{4}$ " loom to cover a couple of the smaller looms to declutter the wiring.

Run the wires down the front of the engine to the sending units.



Attach the gauge sensor wires to the correct sensor.

OBD 2 Port



Locate the OBD 2 port on the 2"x 2" tube to the right of the steering wheel.

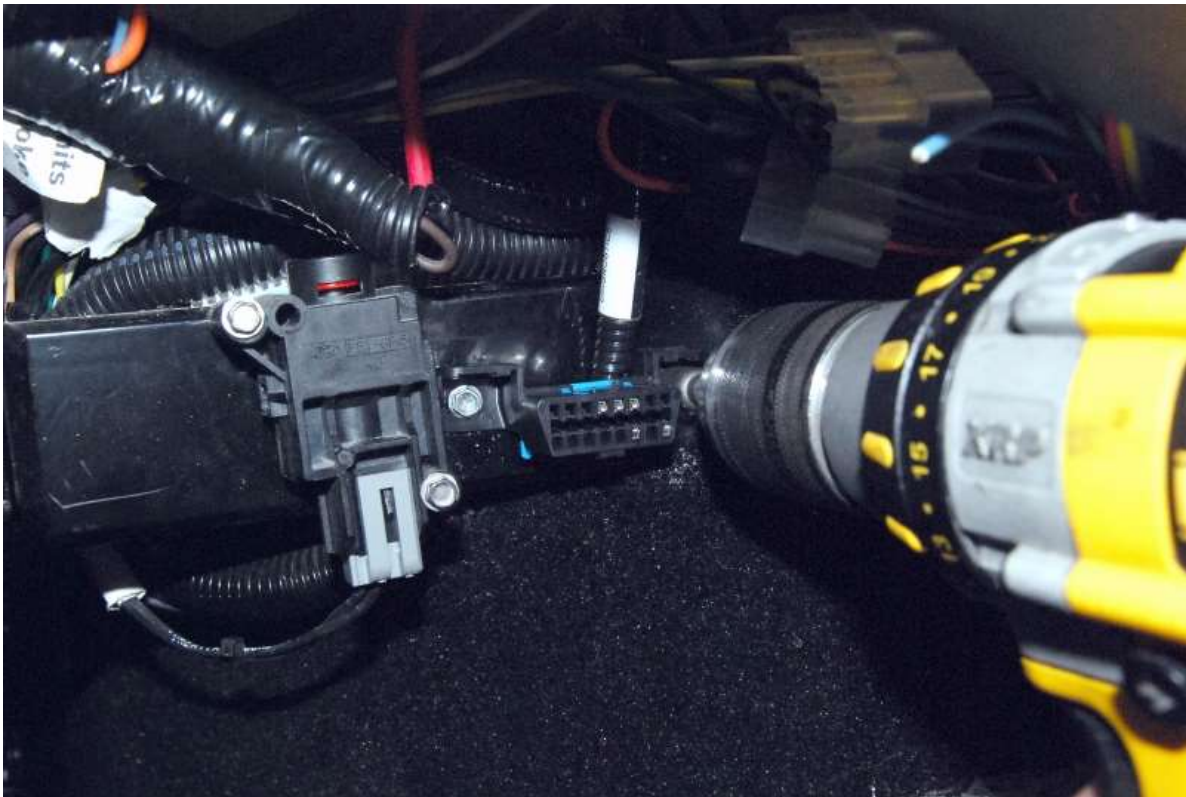

Use some of the aluminum panel #6 screws to attach the OBD 2 plug to the frame.

Clutch cable



Attach the clutch cable to the quadrant and to the clutch fork.

Exhaust

- ✂ 15mm, 17mm sockets, 15mm wrench
- 🚗 Coyote headers, straight pipes
- 👤 Insert and tighten all of the bolts by hand before tightening any with a wrench.

Attach the headers to the engine.

O₂ Harness

- ✂ 18mm wrench.
- 👤 The left and right side O₂ sensor wires are different lengths, the long one is for the right side.



Screw the O₂ sensors into the exhaust.



Attach the right O₂ sensor to the connector at the back of the head.



Connect the left O₂ sensor to the connector down near the engine mount

Starting the engine

 Oil, Coolant

If not already done, fill the engine with 8 quarts of the correct oil.



If not already done, fill the engine with coolant through an inline filler or radiator cap. To help remove air from the system, remove the top cap until coolant starts going up the tube then recap and hose clamp.

Fill the coolant overflow container.

Set the Fuel pressure regulator to the correct pressure as described in the Ford Racing engine control instructions.

Start the engine and allow the engine to get up to 195°F- 200°F then allow to cool completely, it will suck coolant from the overflow.

👉 Cooling fan is switched on at 195°F, turns off at 190°F. This is based on inferred engine coolant temperature. Engine coolant temperature is inferred from the cylinder head temperature. Inferred coolant temperature may not be the same as actual coolant temperature.

Once cool, check the radiator/inline filler neck and coolant overflow container. Top up with coolant if necessary.